

Foundation designed assuming ground is capable of min 100KN^2 at the stated depth. Any footings close to any trees increase depths to NHBC guidelines. Unreinforced bases min 50mm concrete binding to prevent weathering. Use mass concrete designated mix CENS and to comply with BS 5328 and supplied by Q.S. RMS approved plant. External footings min 600mm wide x 1000mm deep. Any tree roots found in excavations increase depth of footings by 330mm below lowest found root. All formation levels agreed on site by L.A. Building Control. All new and existing drains passing through footings to be sleeved or concrete lintols over pipework and to L.A. approval.

All walls below DPC to be 350mm wide cavity. Inner leaf of 100mm concrete blockwork (TKN) or semi-engineering brickwork - 100mm cavity filled with lean mix concrete upto 225mm below DPC level. Outer leaf of semi-engineering brickwork. Top slay outer leaf with perpended joints and fix weep holes at 900mm ctrs. First course of wall ties positioned one course below DPC level. Use 100mm flexible pitch polymer DPC bedded on 1:3 sand cement mortar to internal and external walls. DPC positioned 150mm above finished ground level. DPC joints lapped min 150mm. All new and existing below ground F.W drains adjust with $\phi 100\text{mm}$ UPVC pipework and layed at a self cleaning gradient on a selected bed backfill and to acceptance of L.A. Building Control.

New soakaways - Min 5m from new extension. Percolation tests done to acceptance of L.A. Building Control. Assume content 1.5m^2 below invert level and adjust depth to suite.

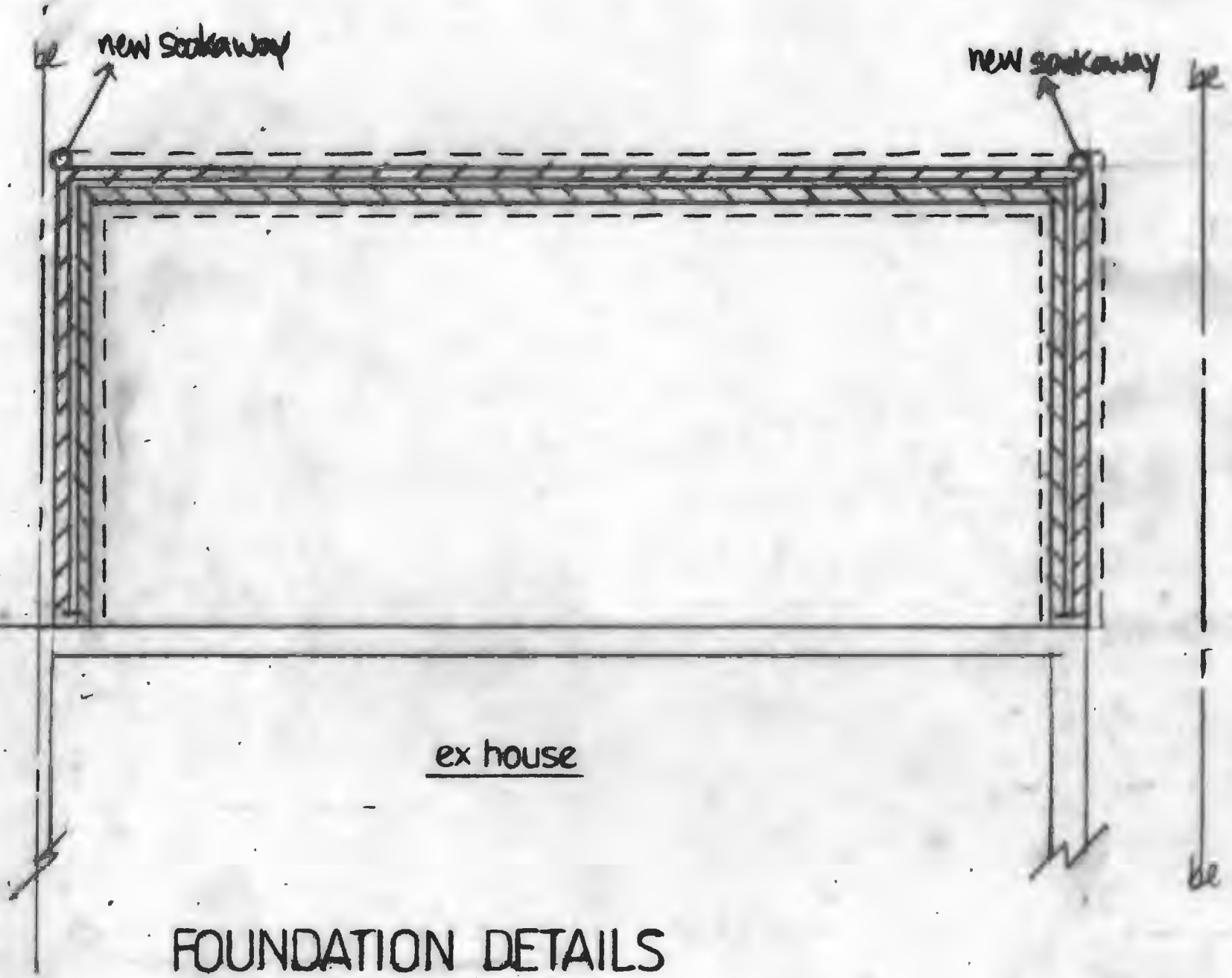

Proposed Extension to 26 Newton Road,
Bromsgrove Scale 1:50