

Proposed natural slate finishes to pitched roof.  
 Proposed dark grey flat roof membrane laid to meet falls.  
 Black painted timber soffit and fascia to match existing house.  
 uPVC Gutter and downpipes to match existing house.

EXISTING FIRST FFL

HALF LANDING FFL

Rough harl render finish to match existing walls.

New black aluminium framed double glazed sliding door units.  
 New black aluminium framed double glazed window units.

EXISTING GROUND FFL

GARAGE FFL

Southwest (Rear) Elevation as Proposed

**Notes:**

Do not scale from this drawing.  
 If in doubt consult the architect.

REV.	REVISION NOTES:	DATE	ISSUED

**inkdesign**  
 architecture

0141 552 2729  
 info@inkdesign.co.uk  
 www.inkdesign.co.uk  
 Unit 6, 141 Bridgegate, The Briggait, Glasgow, G1 5HZ.

**Client**  
 Mr. & Mrs. Anderson  
 42 Calderwood Road  
 Glasgow  
 G43 2RU

**Project**  
 Single Storey Rear Extension with Internal and External alterations. Landscaping works at 42 Calderwood Road Glasgow G43 2RU

<b>Drawing</b>	<b>Scale</b>
Rear Elevation and Section AA as Proposed	1:100 @ A3

<b>Drawn</b>	<b>Checked</b>
EP	MH

<b>Stage</b>	<b>Revision Date</b>
3 - Planning	

<b>Drawing Date</b>	<b>Drawing No.</b>	<b>Revision No.</b>
Mar 21	20-807-PL 13	

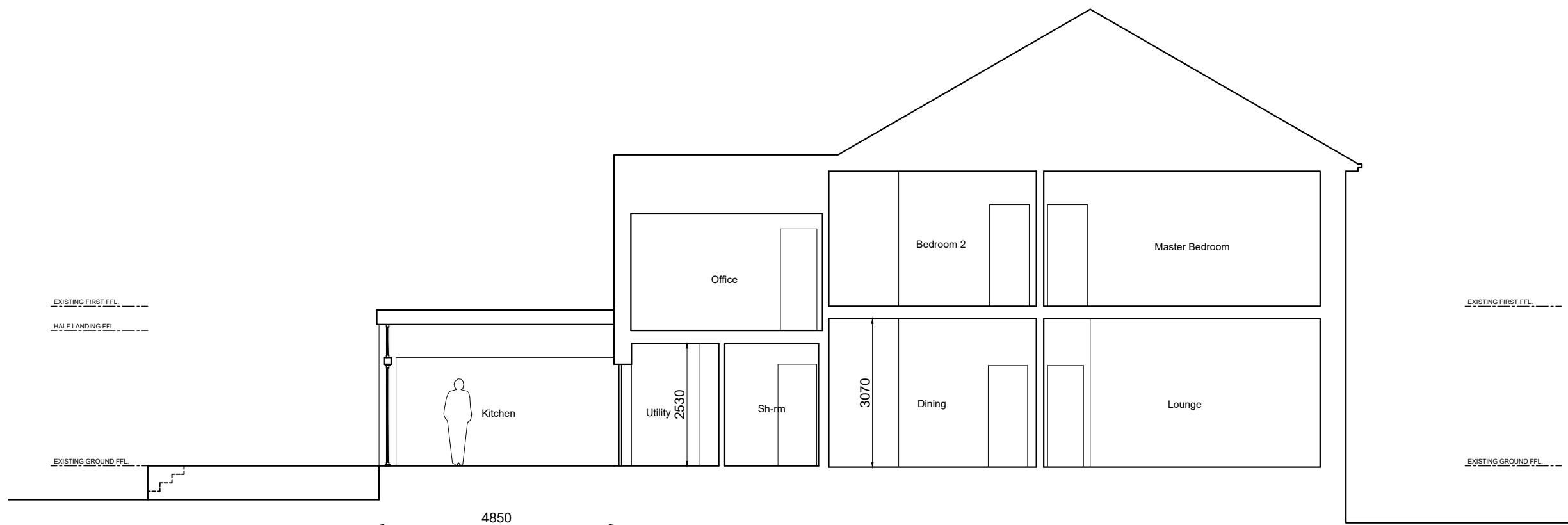

Section AA as Proposed