

Kilbeg Terrace

footpath

boundary line

boundary line

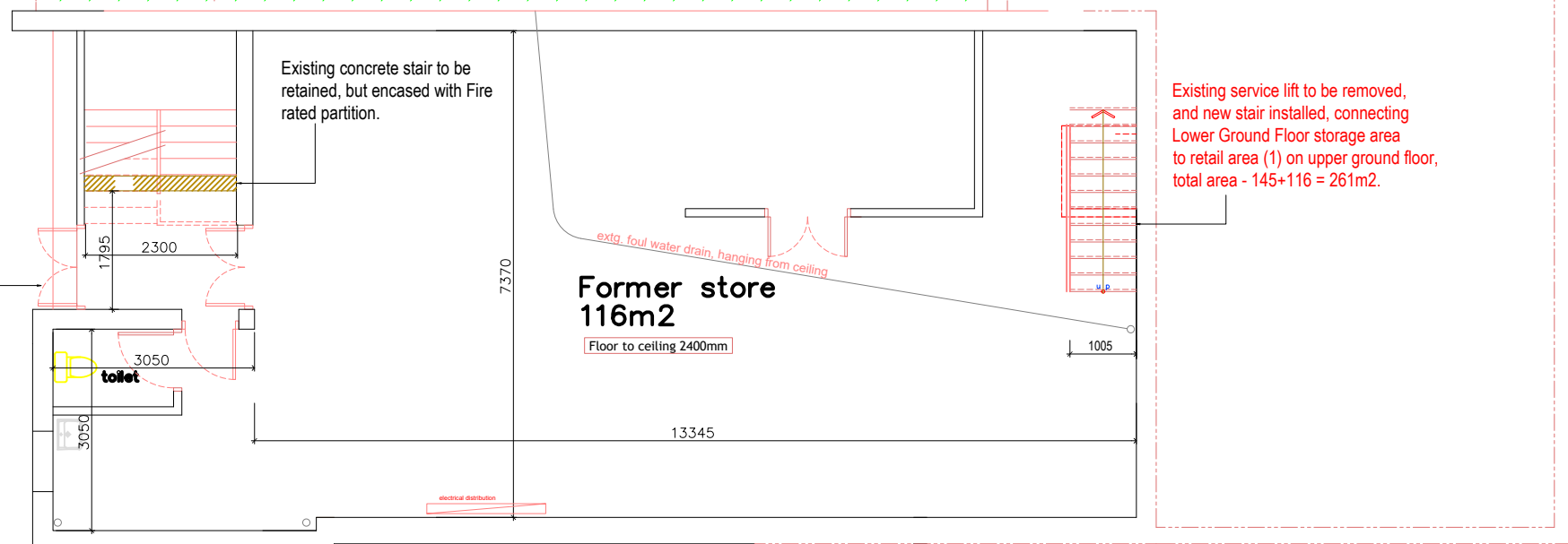
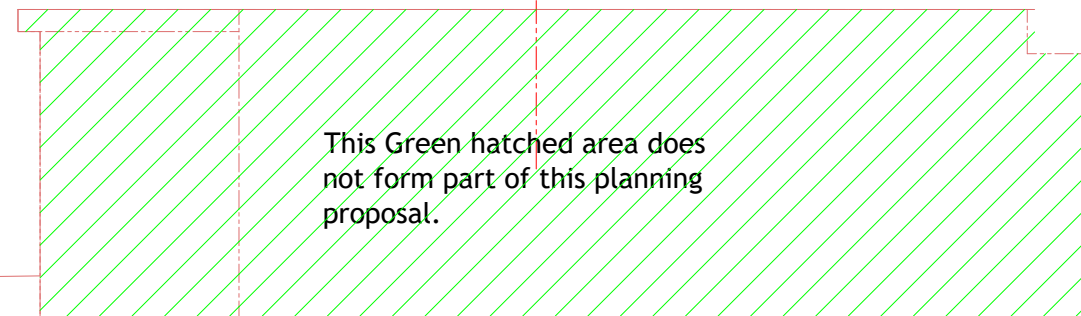

New outward opening double emergency escape doors, exterior of doors finished in galvanised metal.

New concrete steps to provide access to retail premises walkway.

steps

boundary line

footpath

boundary line

footpath

Proposed Lower Ground Floor Plan
scale 1:100

| | | |
|---|---|----------|
| A | Use of storage area clarified for planning officer. | 12.07.21 |
| Rev | Description | Date |
| Planning Application ref.no.21/01701/FUL | | |
| lanarkshireplanz@gmail.com | | |
| Convert former Public Bar (Cullins Bar) into 4no. Retail Unit. | | |
| 53 Kyleakin Road, Thornliebank, G46 8J | | |
| Drawing: | Proposed Lower Grd. Flr. Plan. | |
| Scale: | 1:100 @ A3 | |
| Date: | April 2021 | |
| Drg No: | 3049_PA07_revision 'A' | |