

For Construction purposes do not scale from this drawing
use figured dimensions only

all dimensions to be checked on site

work to be carried out in accordance with by-laws and
regulations of local authorities and statutory undertakers

notes

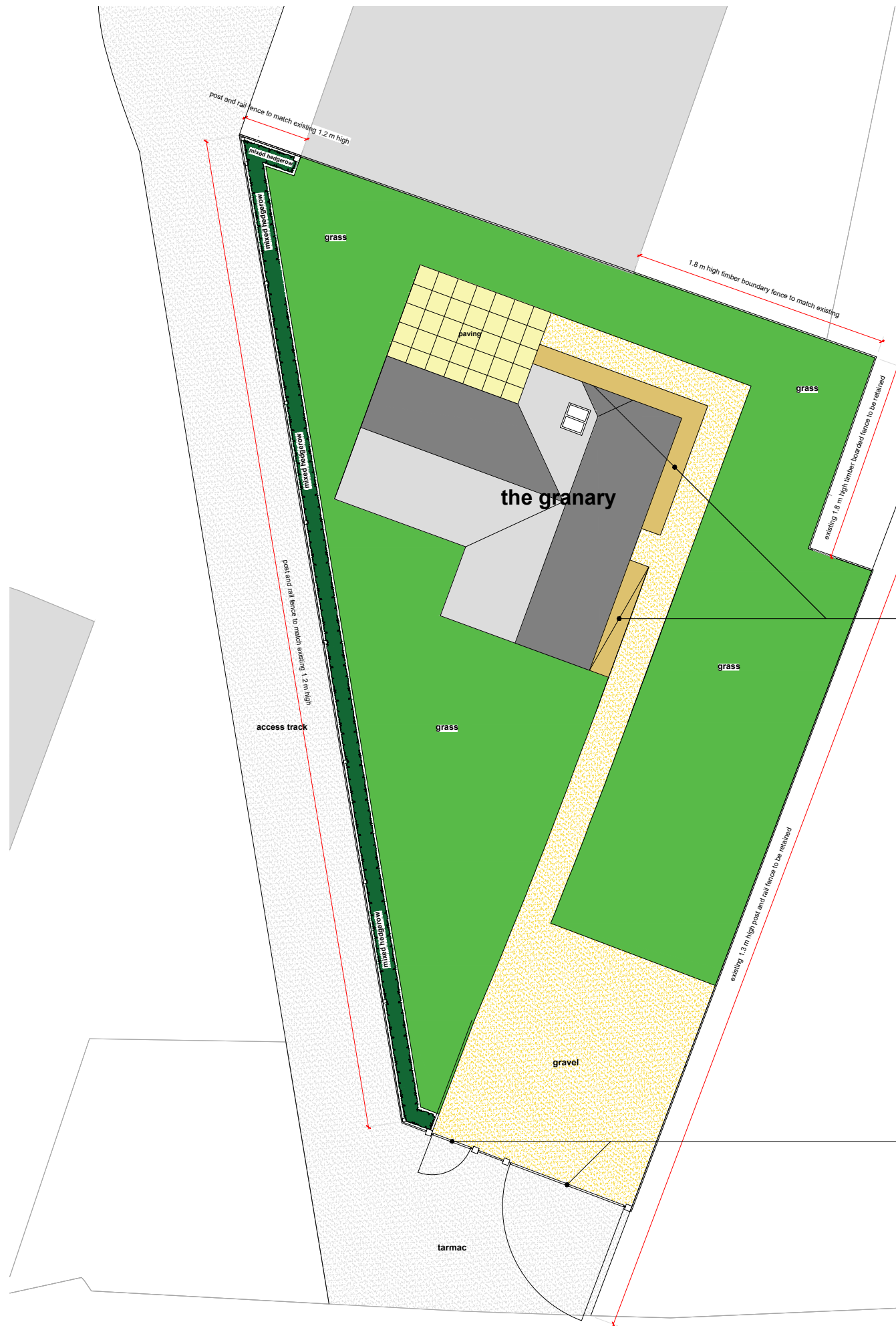

New mixed hedgerow specification:

Hedgerow species mix
Main Matrix (Transplants/Quicks):
70% of planting stock
Hawthorn (*Crataegus monogyna*)
Blackthorn (*Prunus spinosa*)

Interplant (Whips/Transplants):
30% of planting stock
Hazel (*Corylus avellana*)
Holly (*Ilex aquifolium*)
Dog Rose (*Rosa canina*)
Field Maple (*Acer campestre*)
Spindle (*Euonymus europaeus*)
Wild Privet (*Ligustrum vulgare*)

Planting Specification

Hedging should be planted in two, staggered rows at a density of not less than 5 per metre with approximately 450 mm between plants in the same row, and 300 - 400 mm between rows. The interplant whips/transplants should be planted within this pattern in groups of 2 to 3.

Cultivation

All hedgerow planting should be carried out in accordance with BS4428:19+89, Code of practice for general landscape operations (excluding hard surfaces). Hedgerow shrubs should either be notch planted or trench planted. Hedge trenches should be dug to a minimum depth of 400 mm and a width of 600 mm, with the plants put into the ground at the same depth at which they had previously been grown in the nursery. All plants need to be well heeled in after planting and watered in during dry weather. Most hedging plants are supplied as bare root specimens, and it is important to make sure that the roots do not dry out, therefore it is advisable to keep them under a moist cloth or in a bucket of water during planting. Hedges should only be planted between November and March, while plants are still dormant. Avoid planting in very cold or wet weather.

Protection

The planted hedgerow should be protected from rodent damage with spiral tree guards or the use of rabbit netting which can be removed once the plants are well established (approx 3-5 years). To prevent weed competition an area 1 metre across should be cleared of vegetation in line with the new hedge and weed control in the form of mulch should be applied to a minimum depth of 100 mm and maintained until plants are well established. Alternatively, mulch mats may be used.

Management (including grassed areas and border planting)

The health and condition of all plants shall be monitored and maintained for a period of five years from the completion of the development. Any plants which within this period die, are removed or become seriously damaged or diseased shall be replaced in the next planting season with others of similar size and species unless the Local Planning Authority give prior written permission to any variation.

low level herbaceous planting
between house and gravel path

five bar gate and 1.2 m wide
pedestrian gate to match

Little Grigg Farm - Old Granary

Landscaping

approx. 1:150 @ A3

Drawing Number

Rev

03.200

-