

Proposed Rear Elevation

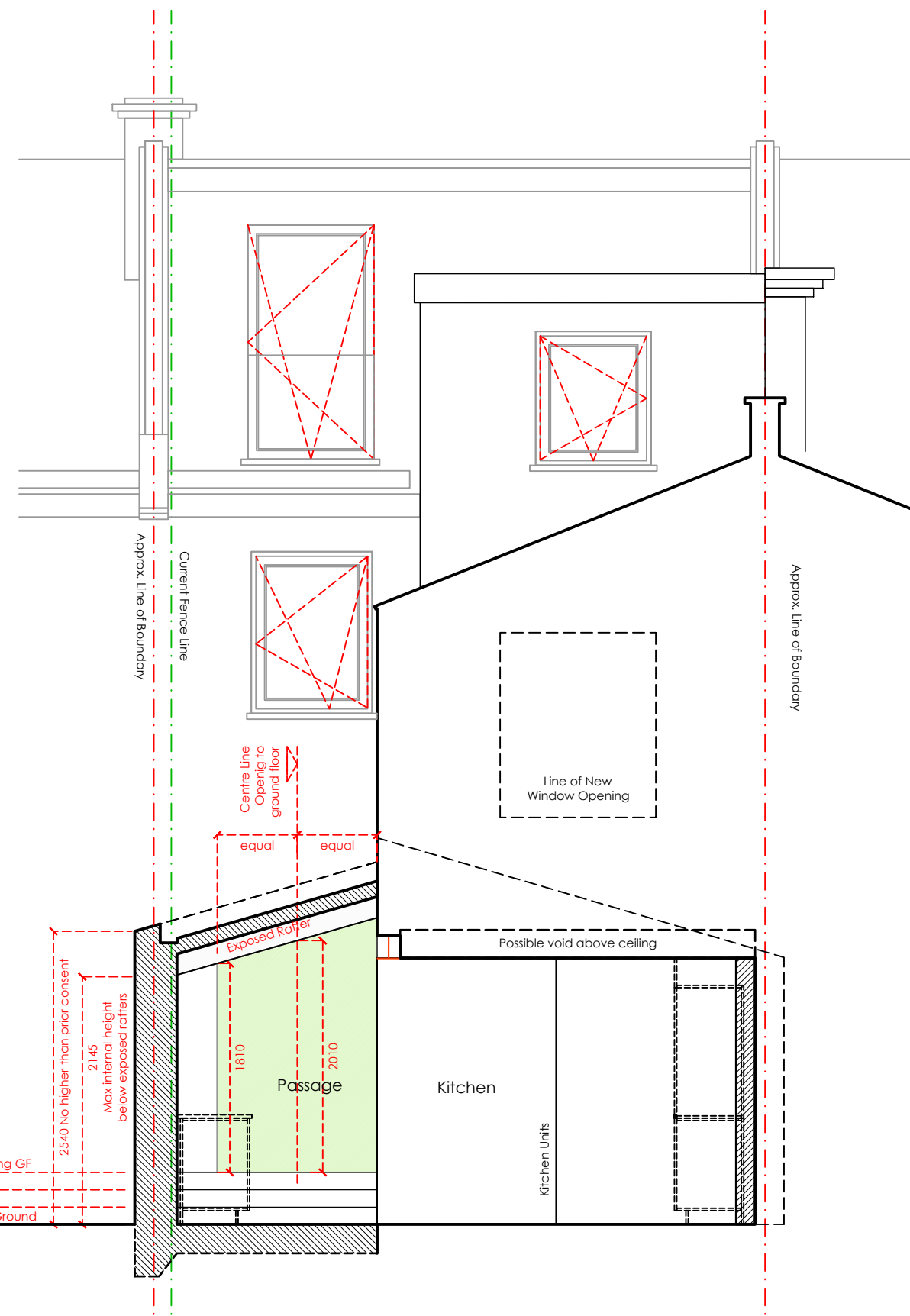

Proposed Section AA

Note . All Dimensions in mm.

New internal and external walls and floors.

-- 14.09.2021 first issue

JW SR

rev. date details

drawn by checked by



1.50_A3
1.25_A1

D I S T R I C T

Blackwater Studio . Unit 4 . 17-19 Blackwater Street . East Dulwich . London . SE22 8RS
+44 (0)7525 179 525
studio@districtarchitects.co.uk
www.districtarchitects.co.uk
this drawing is copyright .

Planning	Proposed . NMA Application Elevation and Cross Section
project	17 Hansler Road East Dulwich . London . SE22 9DJ
client	Mr and Mrs Macartney
job no . 048 . (3) stage	.3 type / place .201 series / number
	-- revision