

Notes:

- Do not scale.
- The contractor is responsible for checking dimensions, tolerances and references. Report all discrepancies to David Bellamy Consulting Limited before proceeding with the works.
- Where an item is covered by drawings to different scales the larger scale drawing is to be worked to.

COPYRIGHT: David Bellamy Consulting Limited own the copyright to this drawing. Their written consent must be obtained before this drawing is copied or used for any purpose other than the one for which it was supplied.

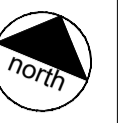

Existing mechanism dating from the original Rag Room processes to remain in place and be protected through the duration of the Works.

Existing vaulted ceiling above Offices F4 & F5 to remain in place and be protected through the duration of the Works. Make good any damage caused.

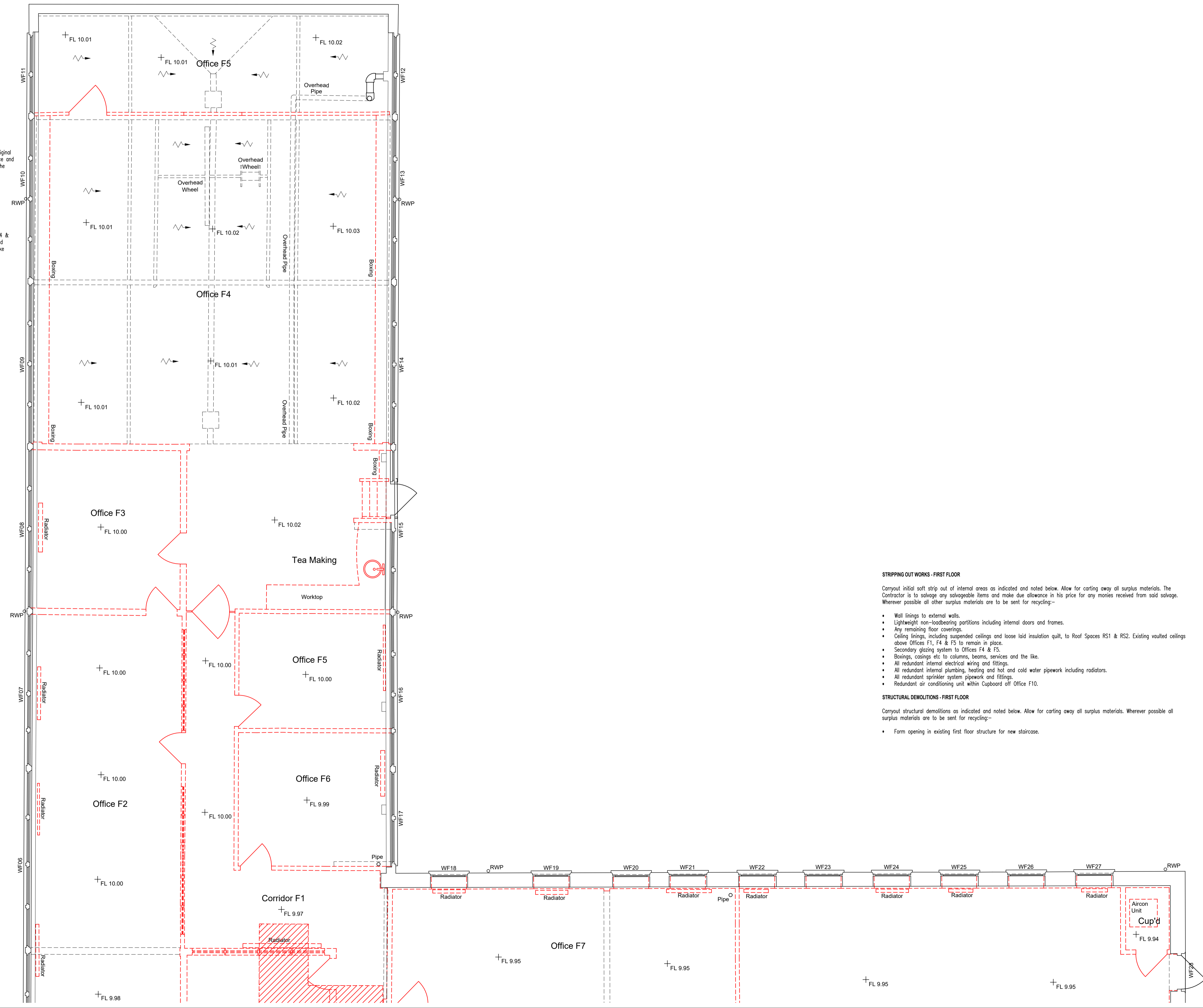

**STRIPPING OUT WORKS - FIRST FLOOR**

Carryout initial soft strip out of internal areas as indicated and noted below. Allow for carting away all surplus materials. The Contractor is to salvage any salvagable items and make due allowance in his price for any monies received from said salvage. Wherever possible all other surplus materials are to be sent for recycling:-

- Wall linings to external walls.
- Lightweight non-loadbearing partitions including internal doors and frames.
- Any remaining floor coverings.
- Ceiling linings, including suspended ceilings and loose laid insulation quilt, to Roof Spaces RS1 & RS2. Existing vaulted ceilings above Offices F1, F4 & F5 to remain in place.
- Secondary glazing system to Offices F4 & F5.
- Boxings, casings etc to columns, beams, services and the like.
- All redundant internal electrical wiring and fittings.
- All redundant internal plumbing, heating and hot and cold water pipework including radiators.
- All redundant sprinkler system pipework and fittings.
- Redundant air conditioning unit within Cupboard off Office F10.

**STRUCTURAL DEMOLITIONS - FIRST FLOOR**

Carryout structural demolitions as indicated and noted below. Allow for carting away all surplus materials. Wherever possible all surplus materials are to be sent for recycling:-

- Form opening in existing first floor structure for new staircase.

Rev.	Date.	Description.
A	09.11.21	General amendments. Issued for Planning

David Bellamy Consulting Ltd  
Architectural Consultants

9 Recreation Way  
Kemsley  
Sittingbourne  
Kent, ME10 2RD.  
T: 01795 479893



Project Title:  
**Proposed Refurbishment of  
Springfield Rag Room,  
Mill Lane, Maidstone,  
Kent, ME14 1GU.**

For Harrisons Chartered Surveyors.

Drawing Description:  
**First Floor Plan - Sheet 2.  
Demolitions.**

Scale: <b>1:50 @ A1</b>	Date: <b>Oct 21</b>
Drawn By: <b>DB</b>	Checked By: <b>DB</b>

Purpose: <b>PLANNING</b>	Revision: <b>A</b>
-----------------------------	-----------------------

Drawing No.  
**20/0511/103**