

KEY

- +0.00 Proposed Engineer's Contours
- Native whip planting with selected standard nurse trees
- Areas to be hydroseeded with native heathland seed mix using locally sourced seeds. Supplier to be specified by an Ecologist - mix to include Heather Calliuna vulgaris and Bell Heather Erica cinerea.
- Areas to be native structural shrub mix - See schedule
- Proposed gravel road surface to Engineer's specification
- Ecological area, refer to DAS
- Allotment Area
- BFS 2 - Acid grassland wildflower seed mix for sandy or peaty soils
- Proposed native hedgerow - See schedule
- Post and rail fence

TREES

- Betula pubescens
- Orchard species
- Prunus padus 'Albertii'
- Sorbus acuparia
- Pinus Sylvestris

NOTES

- This drawing should be read in conjunction with all drawings and the landscape specification submitted.
- This drawing is based upon topographical survey by SUMO Services - SUMO-4068 dated 05.08.21.

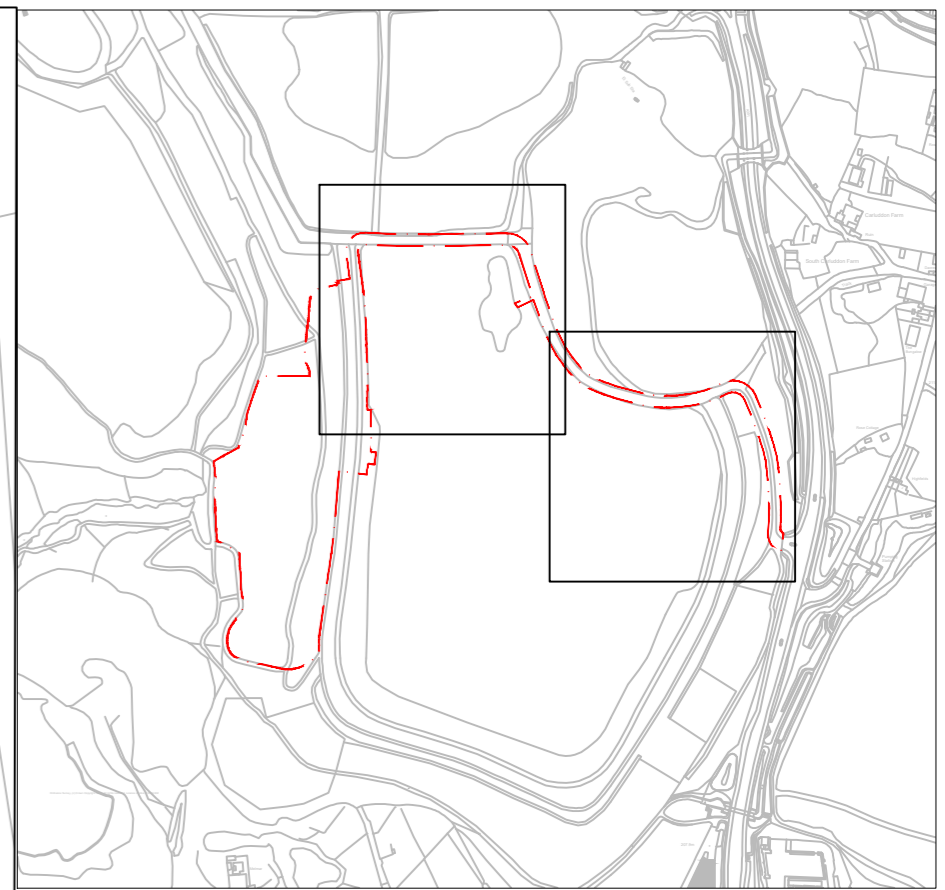
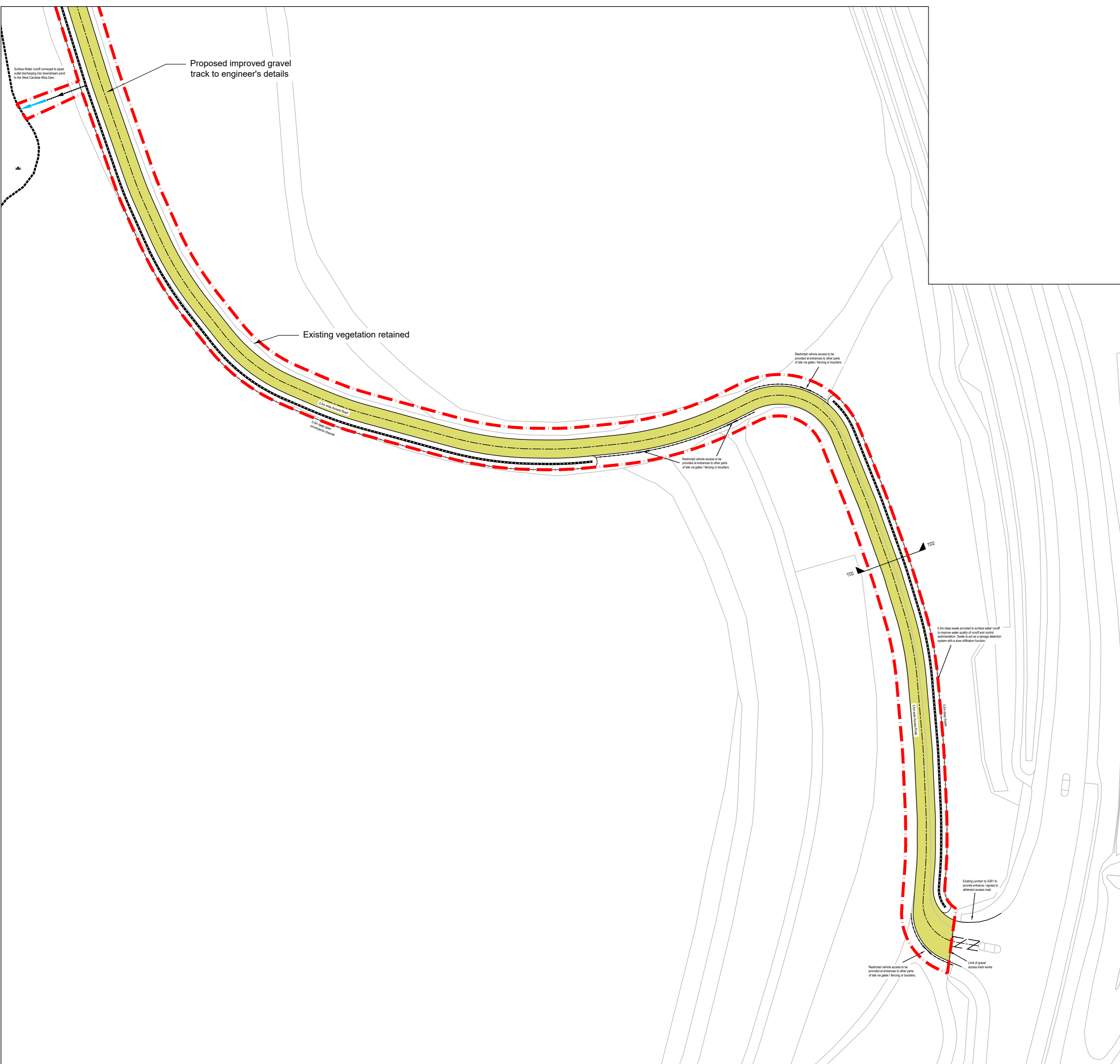

P1	08/10/21	ISSUE FOR PLANNING	RS / SH
REV	DATE	COMMENTS	AUTHOR / CHECKED
PROJECT TITLE			
West Carclaze Garden Village			
DETAIL			
Allotment Area - RMA (2 of 2)			
DRAWING NUMBER			
(PROJECT-ORIGINATOR-ZONE-LEVEL-TYPE-ROLE-NUMBER)			
21081 -LHC - 00 - 00 - DR - L - 0102			
STATUS			
STATUS DESCRIPTION			
D2 FOR PLANNING			
REVISION	DATE	SCALE	
P2	AUG 2021	1:750 @A1	
CONTRACTORS MUST CHECK ALL DIMENSIONS ON SITE - ONLY FIGURED DIMENSIONS ARE TO BE WORKED FROM - DISCREPANCIES MUST BE REPORTED TO THE ARCHITECT BEFORE PROCEEDING			LHC PROJECT NUMBER
© THIS DRAWING IS COPYRIGHT			21081WCGV