

NOTE - Responsibility is not accepted for errors made by others in scaling from this drawing. All construction information should be taken from figured dimensions only

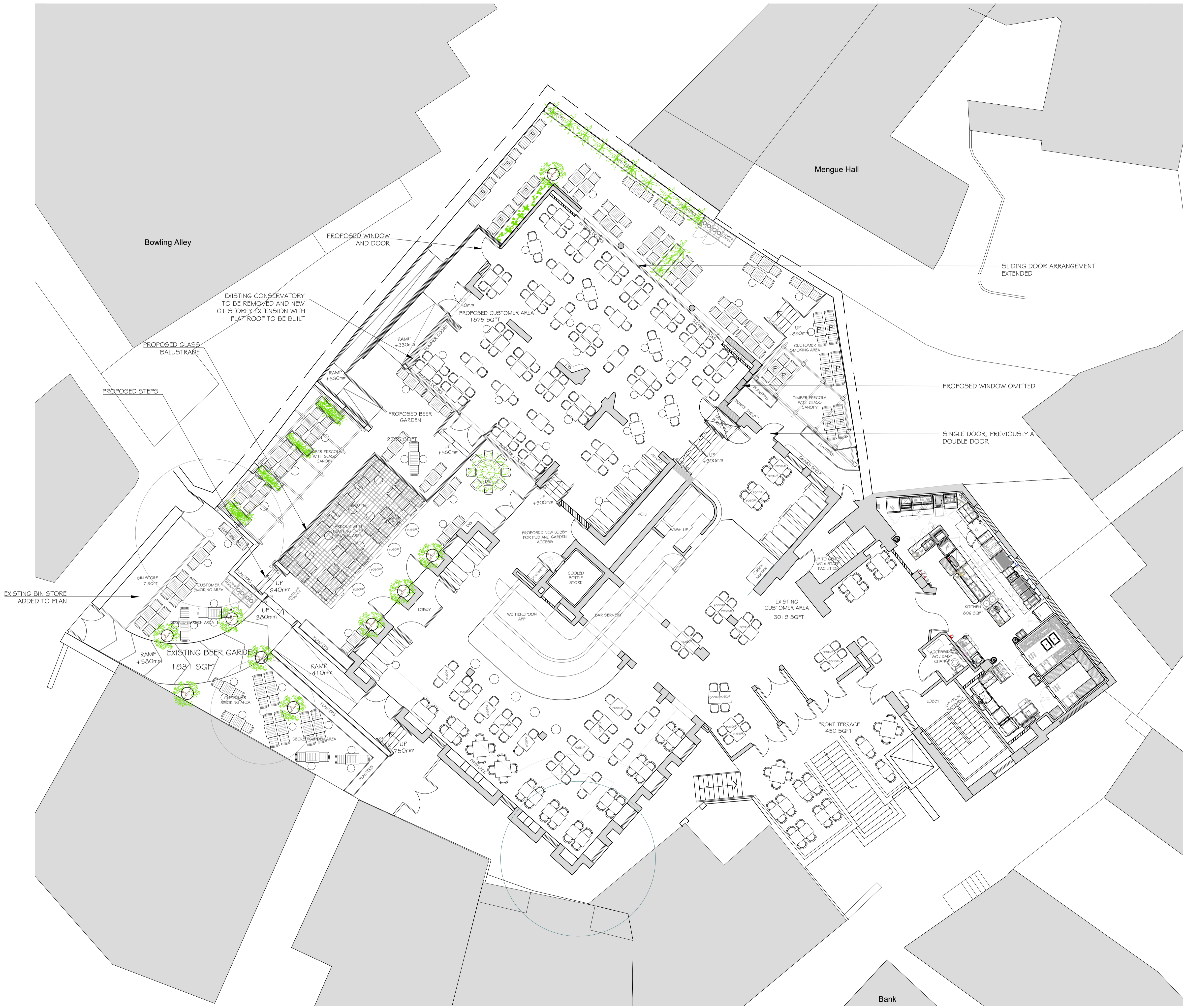
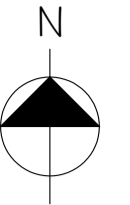
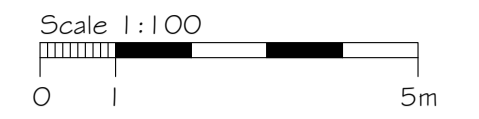

- REVISIONS:
- REV A: RAISED AREA WITH S/STEEL / GLAZED STRUCTURE WITH CANOPY ADDED TO GARDEN, SLIDING DOORS ADDED, BOOTH SEATING REVISED TO SUIT. ALS 19.02.19
  - REV B: SLIDING DOORS REMOVED, STEPS TO CANOPY AREA TAKEN OUT, BOOTH SEAT TAKEN OUT IN CANOPY AREA TO ALLOW FOR NEW DOOR ID 06.03.19
  - REV C: RETAINING EXISTING CONSERVATORY, AMENDMENT TO EXTENT OF SLIDING DOORS. EXISTING BIN STORE ADDED. PROPOSED BALUSTRADE. NC 26.04.21
  - REV D: EXISTING CONSERVATORY TO BE REMOVED AND NEW 01 STOREY EXTENSION WITH FLAT ROOF ADDED LFC 22.11.21
  - REV E: RED LINE REMOVED FROM PLAN AS PER PLANNERS REQUEST LFC 25.11.21

PLANNING

**kdpa**

Basepoint Business Centre, Little High Street,  
Shoreham by Sea, West Sussex BN43 5EG  
+44 (0)1273 467518 www.kdpaine.co.uk

CLIENT	JD WETHERSPOON PLC		
PROJECT	PUB 544 I THE RANN WARTHIA, BIDDICKS COURT, ST AUSTELL, CORNWALL, PL25 5EW		
DRAWING	GA - PROPOSED GROUND FLOOR NEW PUB EXTENSION & NEW STAFF AREA WITH PROPOSED BEER GARDEN		
SCALE	DATE	DRAWN	
A1/1:100	FEB 2019	LA	
PROJECT No	DRAWING No	REVISION	
7253	GA-PP-101	E	