

This drawing should not be scaled and any dimensions verified on site.  
 All dimensions are in millimetres unless otherwise stated.  
 CWIC is the Central Wales Infrastructure Collaboration project between Powys County Council and Ceredigion County Council and all copyrights are vested in each respective Authority.  
 This drawing is the property of CWIC Engineering Design Services and is issued on the condition that it is not copied, reproduced, retained or disclosed to any unauthorised person, either wholly or in part without the consent in writing of CWIC Engineering Design Services.  
 ©Hafwrfaint y Goron a hawlau cronfa dda to 2022 Arrolwg Drônans 100024419 (Cyngor Sir Ceredigion) & 100023371 (Cyngor Sir Powys)  
 ©Crown copyright and database rights: 2022 Ordnance Survey 100024419 (Ceredigion County Council) & 100023371 (Powys County Council)

**Notes**

Rev	Date	Description	By	Chkd
A	0222	Viewport scales and right of way	A.W	S.K

**Engineering Design Services**

EDS West Manager : Steve Hallows CEng MICE  
 01545 572513 hpw@ceredigion.gov.uk  
 West: Penmorfa, Aberystwyth, Ceredigion, SA48 6PA

EDS East Manager : Gareth Price CEng CEM MICE  
 0345 607 6060 gis.helpdesk@powys.gov.uk  
 North: Rinkhamfield Depot, Pool Road, Newbarn, Powys, SY16 2AF  
 Mid: Courne Hill, Six Road East, Llanfihangel Aber, LD1 8LS  
 South: Newbold Bryzentig, Cambrian Way, Brecon, Powys, LD1 7JR

**LLANFAIR CAEREINION PITCH RE-CONSTRUCTION**

**PLANNING APPLICATION SITE LOCATION PLAN AND DEVELOPMENT SITE PLAN**

By **A. W** Checked **S. K** Approved **AS SHOWN** Scale at A1

Date **FEBRUARY 2022**

Project Number **3187** Drawing Number **PL\_000 - 01** Revision **A**

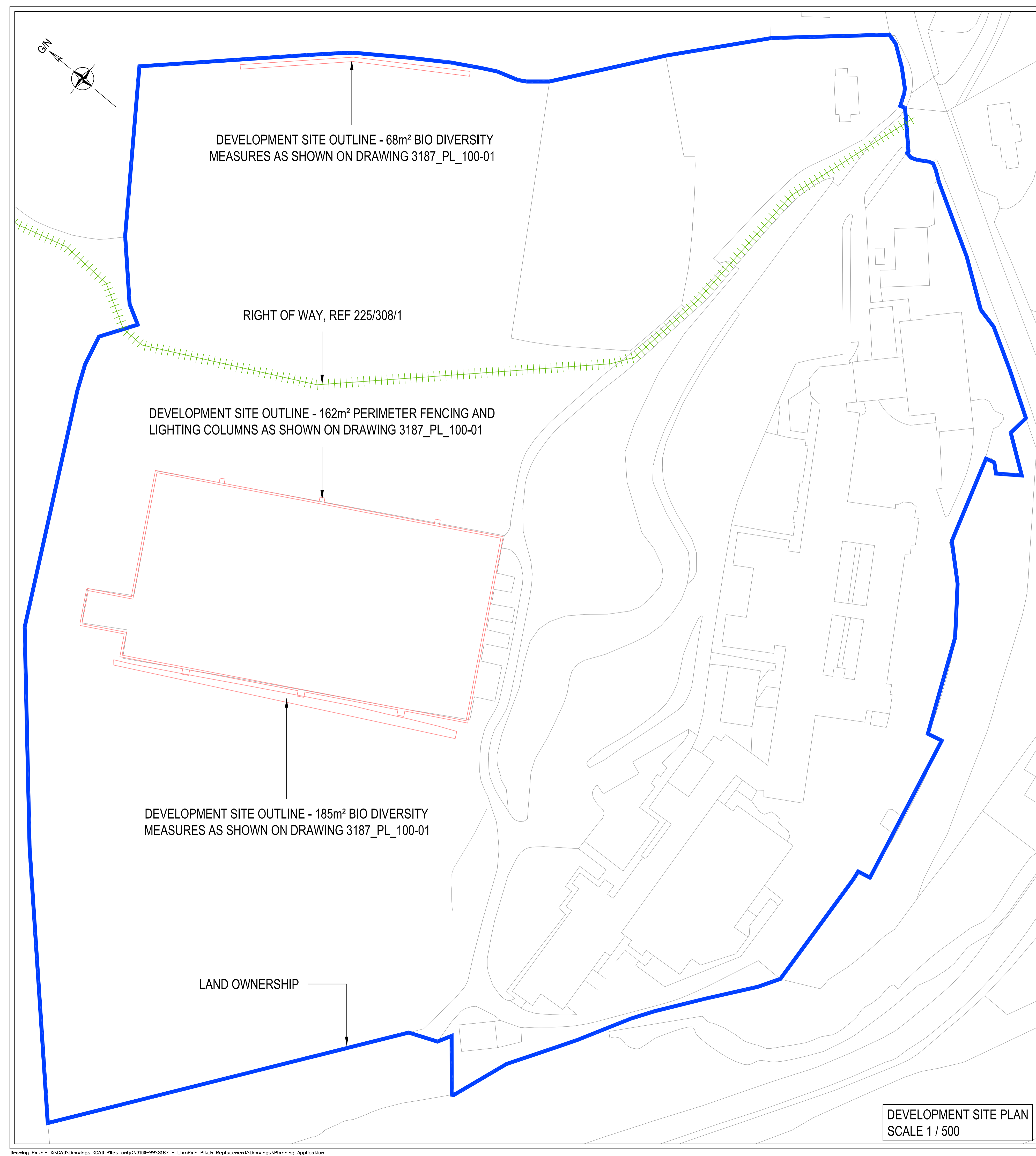

**DEVELOPMENT SITE PLAN**  
 SCALE 1 / 500

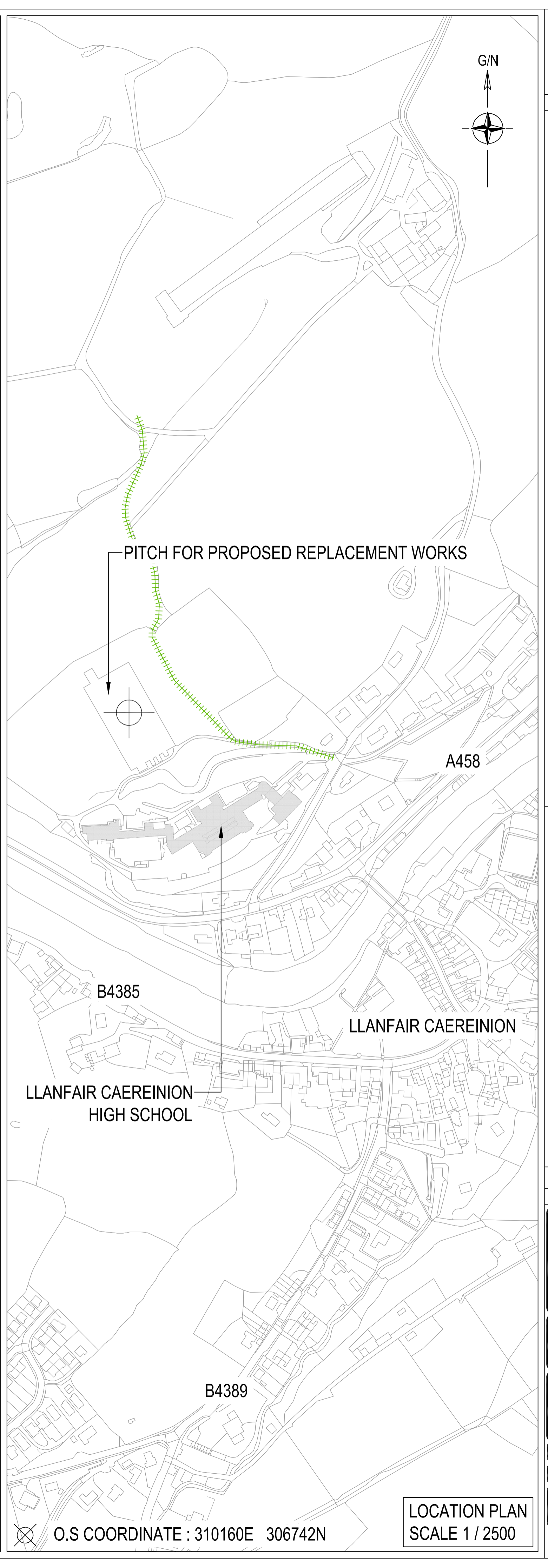

**LOCATION PLAN**  
 SCALE 1 / 2500

O.S COORDINATE : 310160E 306742N