

SECTION 278 GENERAL ARRANGEMENT
SCALE 1:200

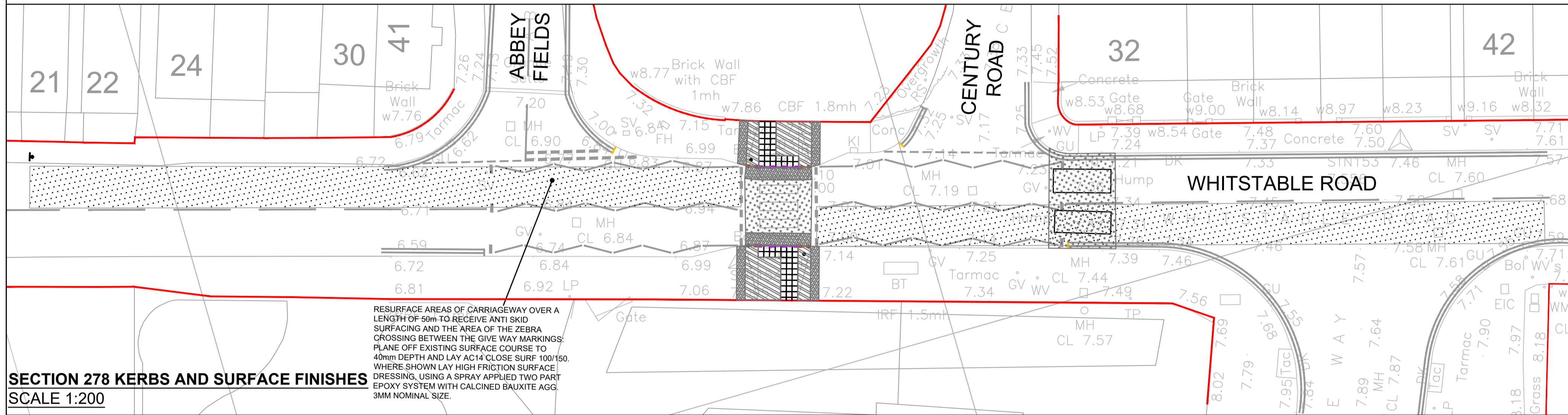

SECTION 278 KERBS AND SURFACE FINISHES
SCALE 1:200

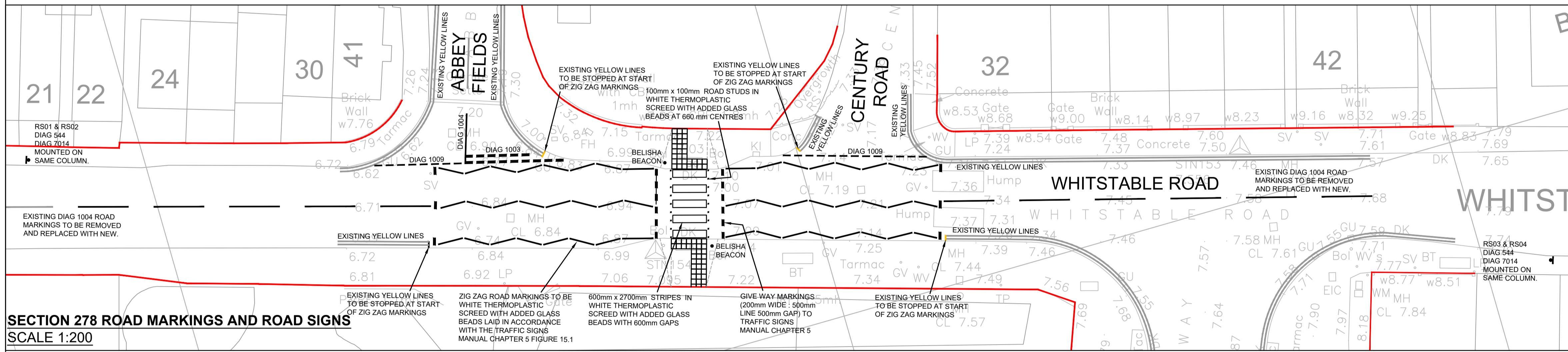

SECTION 278 ROAD MARKINGS AND ROAD SIGNS
SCALE 1:200

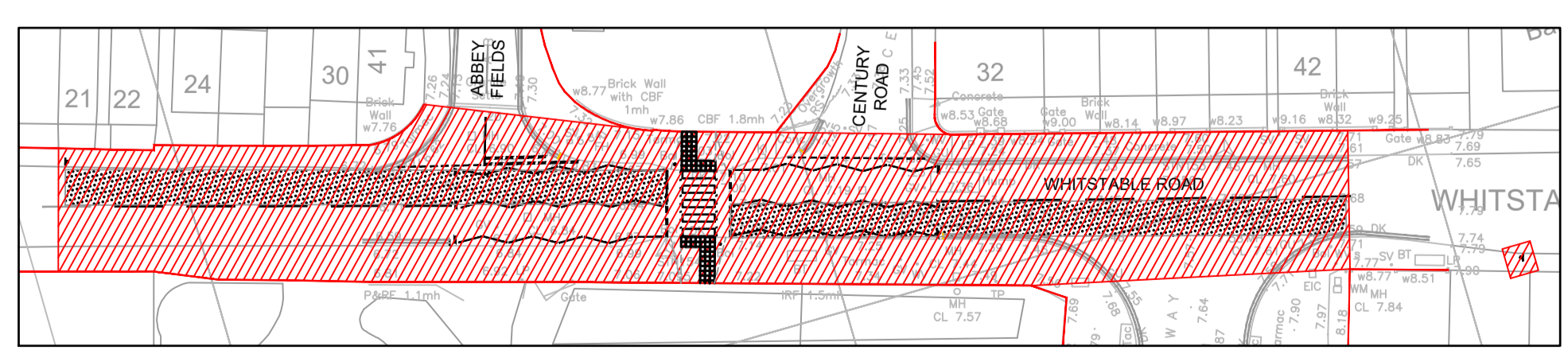

SECTION 278 LEGAL PLAN
SCALE 1:500

CDM REGULATIONS 2015 RESIDUAL HAZARDS	
RESIDUAL HAZARDS IDENTIFIED	
CONSTRUCTION	1. NO SIGNIFICANT RESIDUAL HAZARDS BEYOND THOSE KNOWN TO AN EXPERIENCED CONTRACTOR.
FUTURE DEMOLITION	A. NO SIGNIFICANT RESIDUAL HAZARDS BEYOND THOSE KNOWN TO AN EXPERIENCED CONTRACTOR.

THIS REGISTER IS A NON-EXHAUSTIVE LIST OF RESIDUAL HAZARDS RELATING TO THE WORKS SHOWN ON THIS DRAWING THAT HAVE BEEN IDENTIFIED DURING THE DESIGN STAGE.
IT IS ASSUMED THAT ALL WORKS WILL BE CARRIED OUT BY A CONTRACTOR WITH THE APPROPRIATE SKILLS, KNOWLEDGE & EXPERIENCE, AND IF THEY ARE AN ORGANISATION, THE ORGANISATIONAL CAPABILITY NECESSARY TO FULFIL THE ROLE.

NOTES
CONTRACTORS MUST VERIFY ALL DIMENSIONS ON SITE BEFORE COMMENCING ANY WORK ON SHOP DRAWINGS
DO NOT SCALE FROM THIS DRAWING
RCD CONSULTANTS LTD COPYRIGHT

S278 DRAWING LEGEND	
	FULL DEPTH HRA CARRIAGEWAY CONSTRUCTION
	FULL DEPTH CONCRETE CARRIAGEWAY CONSTRUCTION
	CARRIAGEWAY RESURFACING CONSTRUCTION
	ASPHALT FOOTPATH CONSTRUCTION
	CARRIAGEWAY/FOOTWAY REINSTATEMENT TIE-IN CONSTRUCTION
	SOFT LANDSCAPING VERGE CONSTRUCTION
	TACTILE PAVING
	HIGH FRICTION SURFACING
	355x125 HB1 HALF BATTERED KERB
	255x125 HB2 HALF BATTERED KERB
	150x125 BM DROPPED KERB
	TRANSITION KERB
	150x50 EF EDGING KERB
	EXISTING HIGHWAY BOUNDARY
	AREA OF S278 WORKS
	LAND TO BE TRANSFERRED UNDER S278 AGREEMENT
	ROAD SIGN
	STREET NAME PLATE
	EXISTING LIGHTING COLUMN TO BE RELOCATED

- NOTES
- ALL DIMENSIONS IN MILLIMETERS UNLESS NOTED OTHERWISE.
 - THIS DRAWING TO BE READ IN CONJUNCTION WITH ALL OTHER ENGINEERING DRAWINGS AND CALCULATIONS ASSOCIATED WITH THIS PROJECT.
 - ALL COMPONENTS AND MATERIALS ARE TO BE MANUFACTURED AND SUPPLIED IN ACCORDANCE WITH THE RELEVANT BRITISH STANDARDS, AND LAID AND BACKFILLED IN ACCORDANCE WITH MANUFACTURER'S INSTRUCTIONS AND THE RELEVANT BRITISH STANDARDS.
 - THE CONTRACTOR SHALL, BEFORE COMMENCING THE WORKS, VERIFY ALL SITE AND SETTING OUT DIMENSIONS. THE CONTRACTOR SHALL BE RESPONSIBLE FOR THE TRUE AND PROPER SETTING OUT OF THE WORKS AND FOR THE CORRECTNESS OF THE POSITION, LEVELS, DIMENSIONS, AND ALIGNMENT OF ALL PARTS OF THE WORKS.
 - ALL WORK WITHIN THE HIGHWAY IS TO BE COMPLETED IN ACCORDANCE WITH THE KENT COUNTY COUNCIL HIGHWAYS DEPARTMENT SPECIFICATION AND REQUIREMENTS AND UNDER A SECTION 278 AGREEMENT.
 - ALL ROAD MARKINGS AND ROAD SIGNS ARE TO BE CONSTRUCTED IN ACCORDANCE WITH THE TRAFFIC SIGNS REGULATIONS AND GENERAL DIRECTIONS 2016.

P1	PRELIMINARY ISSUE	09.06.2021	RAC
REV	AMENDMENT	DATE	CHKD
DRAWING STATUS			

PRELIMINARY

RCD

RCD CONSULTANTS LTD
9 BIRCH TREE WAY, MAIDSTONE, KENT, ME15 7RP
MOBILE: 07702 052 137
EMAIL: ray@rcd-uk.com

CLIENT	VINSON TRUST
PROJECT	PROPOSED ZEBRA CROSSING WHITSTABLE ROAD FAVERSHAM
DRAWING TITLE	SECTION 278 LAYOUTS

CIVILS			
SCALE	DRAWN BY	CHECKED	DATE
1:200 @ A1 1:400 @ A3	LD	RAC	JUN 2021
DRAWING NUMBER	REVISION		
1111-2112-CIV-200	P1		

