

This drawing is COPYRIGHT. It must not be reproduced or disclosed to third parties without our prior permission. Do not scale from this drawing, or, interrogate and use electronic information.

Any discrepancies should be reported immediately.

Any surveyed information incorporated within this drawing cannot be guaranteed as accurate unless confirmed by a fixed dimension. All dimensions are in millimetres unless noted otherwise.

Furniture Key	
A	- Two Seat Sofa
B	- Armchair
C	- TV
D	- Large Storage Units (1050x550)
E	- Breakfast Bar with Seating (1500x580)
F	- Double Bed (1500x2000)
G	- Dressing Table (1350x450)
H	- Large chest of Drawers (1050x450)

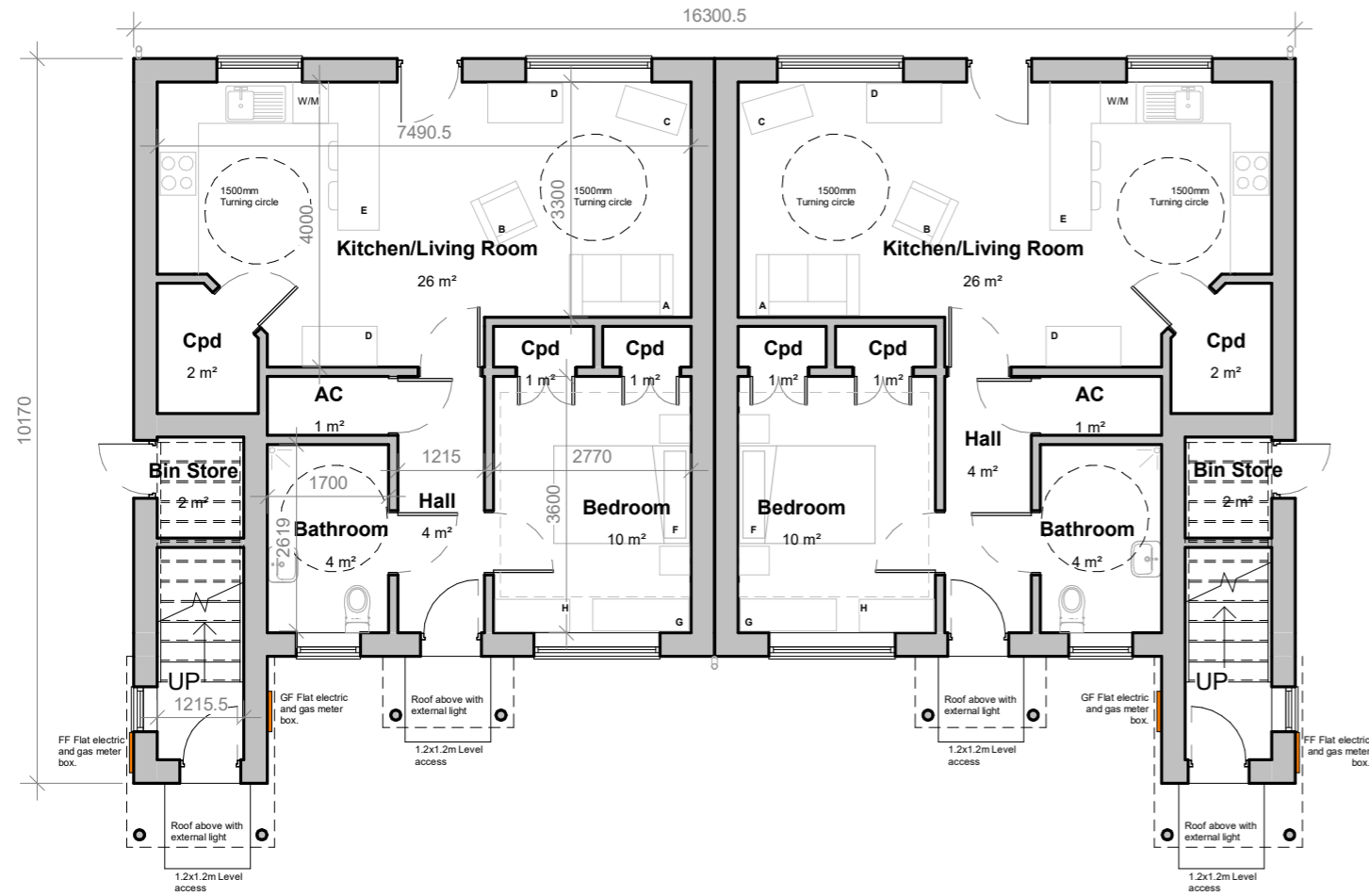

GROUND FLOOR

1 : 100

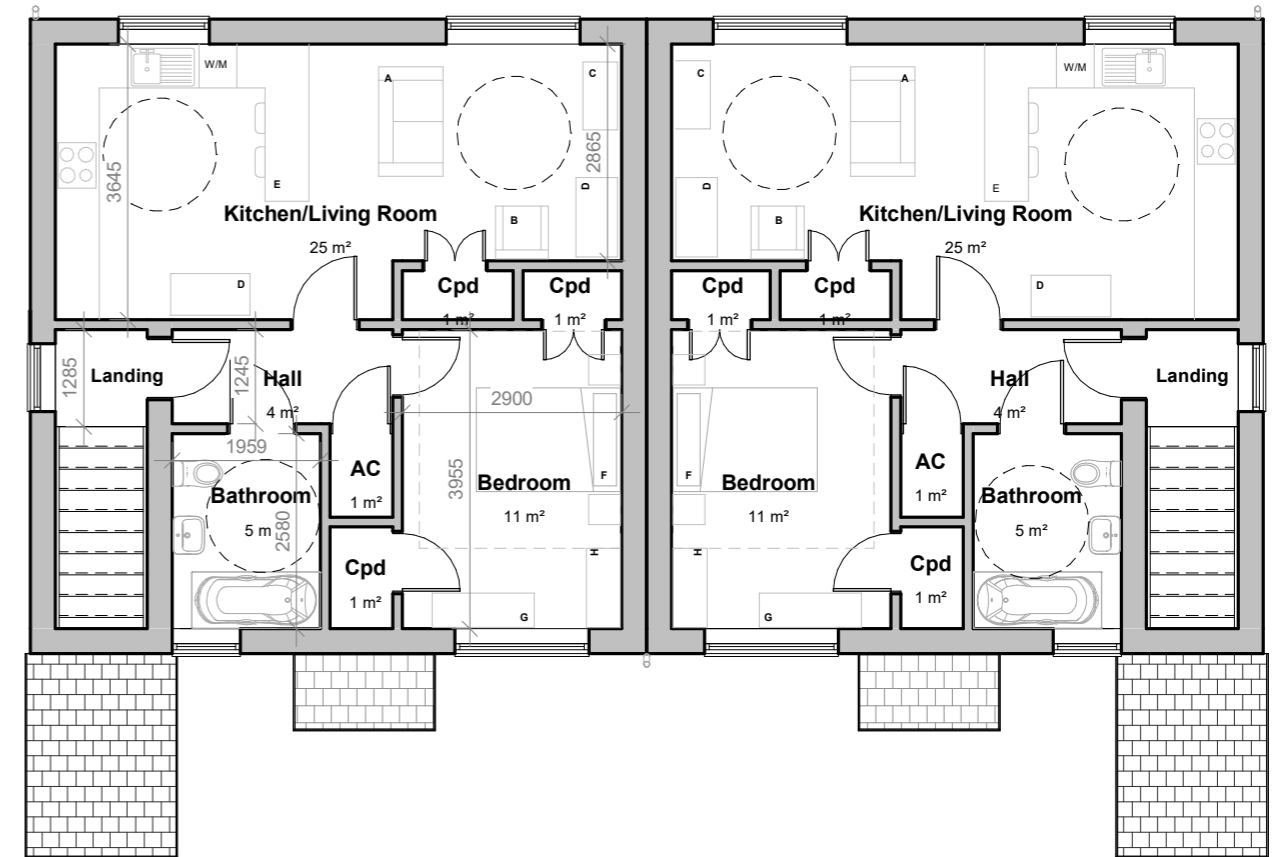

FIRST FLOOR

1 : 100



Head Office
29 Broad Street
Newtown
Powys
SY16 2BQ
t - 01686 610311
w - www.hughesarchitects.co.uk

Rev C - GSP - Minor revisions following client comment - 02.02.23
Rev B - GSP - Additions to plan following client comment - 18.01.23
Rev A - GSP - Design changed following client meeting - 09.01.23

Project :- Redevelopment of Pen y Bryn and Ael y Bryn, Ystradgynlais, Powys			
Drawing Status :- Stage 3a Planning		Drawing Title :- Proposed Floor Plans	
Scale :- 1 : 100	Date :- 13.12.22	Drawing No :- X078.3a. 3.300	Rev :- C
Drawn by :- GSP	Checked :- RL		