

Case Ref: 1723/23/RA

Proposal: Extension of office to garage and conversion of garage to habitable room

Location: 3 Belvedere Close, Faversham, Kent, ME13 7GQ

Section 1 – Proposed Extension

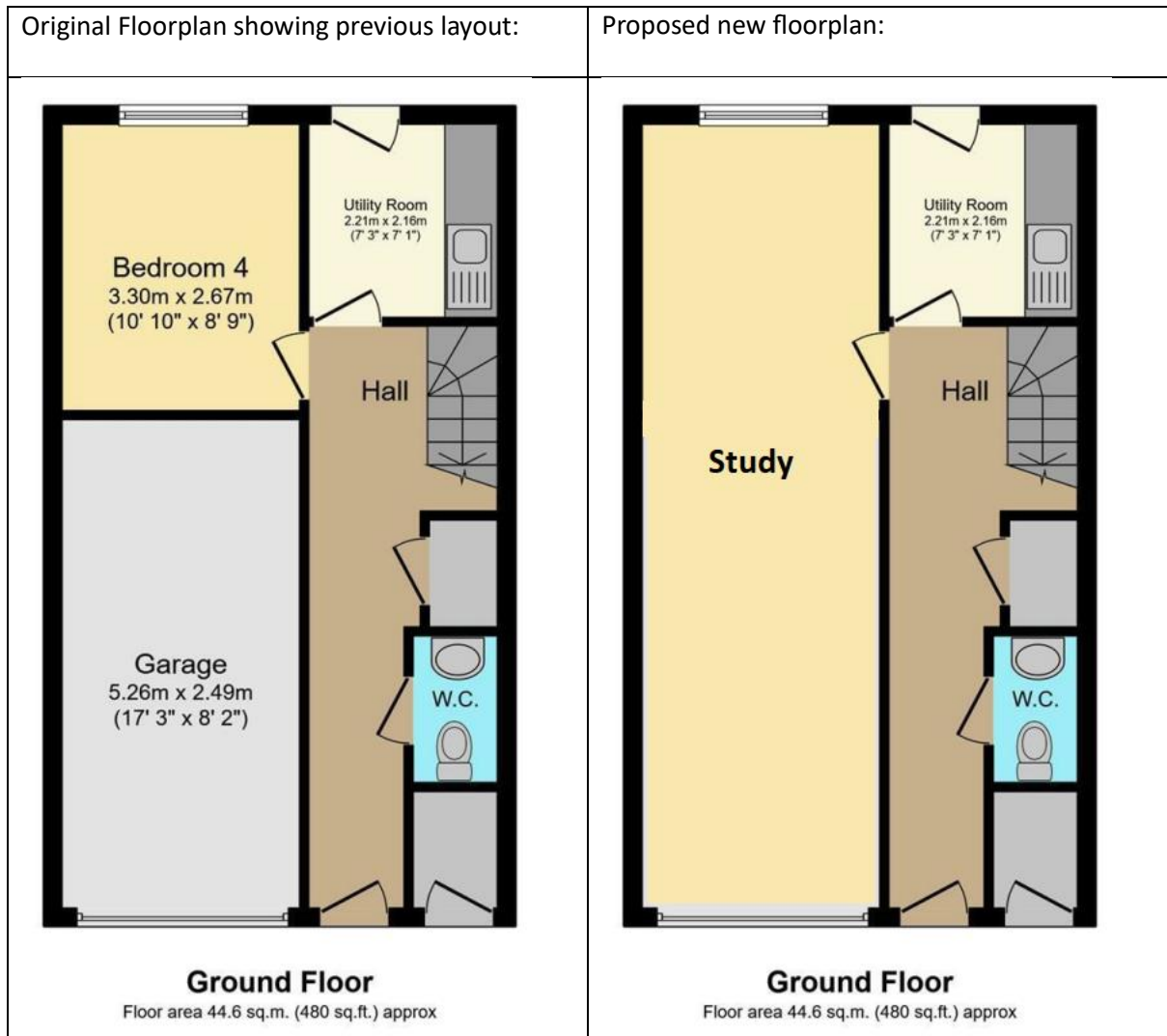

Note that "Bedroom 4" was used as a study since purchase in September 2022.

Section 2 – Work to Date

Floor:

Damp Proof Membrane (1200 gauge, 300 MU)

100mm Celotex (2 sheets of 50mm on top of each other)

Neighbour's Wall:

50mm Rockwall sound insulation (see Photo 1)

Knauf Soundshield acoustic plasterboard (12.5mm, EN520 Types A and D) - product specification sheet: <https://www.knauf.co.uk/-/media/isolator-test-reports/product-data-sheet---soundshield-plus.pdf>

Front wall:

Double-glazed windows with Pilkington Super-Grey glass: [Pilkington SuperGrey™](#) and [Pilkington Dark Grey™](#)

Current wall is 300mm thick made up of 100mm brick, 100mm cavity filled with 100mm batt of Knauf DriTherm Cavity Slab 37, non-combustible (see photos 2 and 3, product link: <https://www.knaufinsulation.co.uk/products/dritherm-cavity-slab-37>), 100mm breeze blocks

Footing for front wall:

600mm deep x 400mm wide for the 300mm wall. The 600mm foundation was poured on top of existing house foundation.

Garage floor is block and beam floor. That was shuttered off and the 600mm of footing for this was poured onto the ring-beam footing.

Existing hall wall:

Dot and dab 12.5mm plasterboard.

Doors:

Fire doors have been put between study and hall; between utility room and hall; and between W.C. and hall (this was put in after the inspection).

Study and Utility Room doors - Howdens Linear Oak Pre-Finished Clear Glazed FD30 Fire Door. Product link: <https://www.howdens.com/joinery/doors/howdens-linear-oak-pre-finished-clear-glazed-fd30-fire-door-obj-sku-family-25406280>

Cloakroom door - Howdens Linear Oak Pre-Finished FD30 Fire Door. Product link: <https://www.howdens.com/joinery/doors/howdens-linear-oak-pre-finished-fd30-fire-door-obj-sku-family-20137535>

All fire certificates and Howdens receipts are available for inspection for the doors.

Electrical certificates:

Electrical work carried out by Sait Electrical Services (registered electrician), 8 Magnolia Rise, Herne Bay, Kent CT6 7A. Certificate to be submitted by Sait Electrical directly to building regulations.

Section 3 – Photographs



Photo 1 – Acoustic insulation



Photo 2 – Cavity Insulation



Photo 3 – Cavity Insulation