

Notes:
 The drawing and the works described are the copyright of Boyer.
 This drawing is for planning purposes only. It is not intended to be used for construction purposes. Whilst all reasonable efforts are used to ensure drawings are accurate, Boyer accept no responsibility or liability for any reliance placed on, or use made of, this plan by anyone for purposes other than those stated above.
 Do not scale from this drawing. All contractors must visit the site and be responsible for taking and checking Dimensions.

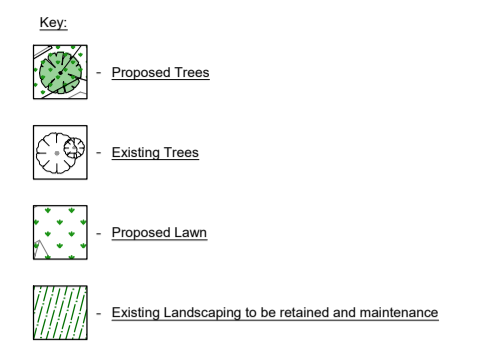

TREE PLANTING

ANY EXISTING TREES THAT ARE SHOWN TO BE RETAINED, THAT SUBSEQUENTLY DIE DURING THE COURSE OF CONSTRUCTION, SHALL BE REPLACED WITH A DIRECT REPLACEMENT TO THE SPECIFICATIONS BELOW.

ALL TREES SHALL BE OBTAINED FROM AN APPROVED LOCAL SOURCE CERTIFIED TO CONFORM TO BRITISH STANDARD BS 3936-1:1992. ANY TREES THAT DIE WITHIN THE FIRST 10 YEARS SHALL BE REPLACED WITH A LIKE FOR LIKE SPECIMEN.

EXTRA HEAVY (SEMI-MATURE) TREES SHALL HAVE A GIRTH OF NOT LESS THAN 140-160mm MEASURED 1m ABOVE GROUND LEVEL AND SHALL HAVE A MIN. HEIGHT OF 3.5m

STANDARD TREES SHALL HAVE A GIRTH OF NOT LESS THAN 80-100mm MEASURED 1m ABOVE GROUND LEVEL AND SHALL HAVE A HEIGHT OF NO LESS THAN 2.5-3m

ALL NEW PLANTS SHALL BE PROTECTED USING BIO-EARTH BIODEGRADABLE PLASTIC-FREE SHELTER GUARD.

ALL TREES SHALL BE SUPPLIED FROM SPECIALIST CONTAINER GROWTH BAGS.

SPECIMENS	Species	Height	Girth	Specification	No.
	Prunus avium	150-275cm	12-14cm	Spec: Measure: 3x-8B Clear Stem min. 200cm Heavy Standard Clear Stem 170-200 3x-5 8x4x-8B	3
	Acer campestre	180-400cm	12-20cm	Spec: Measure: 3x-8B Clear Stem min. 200cm	2
	Viburnum lantana	150-400cm	12-14cm	Spec: Measure: 3x-8B Clear Stem min. 200cm Standard Clear Stem 125-150 3x-5 8x4x-8B	2
				Total	7

PREPARATION FOR TREE PLANTING WITHIN COMPLETED PITS

EXCAVATE HOLE TO EXCEED SIZE OF TREE GROWTH CONTAINER BY AT LEAST 300MM ON ALL SIDES. EXCAVATE PIT TO DEPTH TO GIVE 50MM SOIL COVER ABOVE TOP SURFACE OF CONTAINER PIT.

STAKING OF TREES

SEMI-MATURE TREES SHALL BE RESTRAINED IN THEIR PITS BY MEANS OF UNDERGROUND ANCHORING SYSTEM SUCH AS PLATINUS ANCHORING SYSTEMS INSTALLED IN ACCORDANCE WITH MANUFACTURER'S INSTRUCTIONS. STANDARD TREES SHALL BE STAKED USING 2-3 POINTED TANALISED STAKES DRIVEN INTO TREE PIT OUTSIDE ZONE OF ROOT BOWL AND FITTED WITH TWO REINFORCED RUBBER CUSHIONED TREE TIES TO ALLOW FLEXIBILITY WITHIN STEM OF TREE.

HEDGE PLANTING

SPECIES	Height	Pit Size	Specification	Density	No.
Crataegus monogyna	80-90	2L	Pit Crown	3.5 per linear metres	100
Corylus avellana	80-90	2L	Branches 4x4x4x C	1 per linear metres	30
Acer campestre	80-100	2L		Evenly distribute	2
Ilex aquifolium	80-90	2L		Evenly distribute	48
Prunus lusitanica	80-100	Root Ball	Root Ball	1.5 per linear metres	48

PREPARATION: ALL WORK SHALL BE CARRIED OUT BY HAND ONLY WITH MINIMUM DISTURBANCE TO EXISTING GROUND TO AVOID DAMAGE TO ROOT SYSTEMS. EXISTING HEDGE AND SHRUBS TO BE CUT DOWN TO GROUND LEVEL BUT NOT DUG OUT TO AVOID DAMAGE TO ROOT SYSTEMS. NEW PLANTS TO BE CAREFULLY INSTALLED BY HAND BY NOTCH PLANTING ONLY.

PLANTING: TO BE PLANTED IN DOUBLE STAGGERED ROWS (TRIPLE STAGGERED ROWS TO WESTERN BOUNDARY) 300mm APART 5 PLANTS PER METRE RUN IN EACH ROW AND ALL PLANTS RANDOMLY MIXED TO GIVE AN EVEN SPREAD THROUGH THE HEDGE. NO WORKS SHALL BE CARRIED OUT WITHIN 2000mm OF THE FACE OF ANY ADJACENT TREES.

ALL NEW PLANTS SHALL BE PROTECTED USING BIO-EARTH BIODEGRADABLE PLASTIC-FREE SHELTER GUARD.

MANAGEMENT AND MAINTENANCE NOTE - REFER TO OUR LANDSCAPE MANAGEMENT AND MAINTENANCE PLAN

THE APPROVED LANDSCAPING SHALL BE IN PLACE AT THE END OF THE FIRST PLANTING AND SEEDING SEASON FOLLOWING THE FIRST OCCUPATION. ANY TREES OR PLANTS, WHICH, WITHIN A PERIOD OF 10 YEARS FROM THE COMPLETION OF THE DEVELOPMENT, DIE, ARE REMOVED, OR BECOME SERIOUSLY DAMAGED OR DISEASED, SHALL BE REPLACED IN THE NEXT PLANTING SEASON WITH OTHERS OF SIMILAR SIZE AND SPECIES.

WEEKLY - 5-10 LITRES OF WATER ONCE OR TWICE A WEEK DEPENDING ON THE WEATHER FOR EACH METRE OF HEDGE.

MONTHLY - WEED CONTROL

ANNUALLY - TRIM/PRUNE IN LATE SUMMER/AUGUST & REPLACEMENT OF ANY FAILED HEDGES.

GRASS TO FOLLOW BS 3969:1998 RECOMMENDATIONS FOR TURF FOR GENERAL PURPOSES AND TO BE MAINTAINED BY SUITABLE LAWN CARE MANAGEMENT COMPANY.

A	20.10.23	Updated in line with client comments	AW	AW
-	17.10.23	Final Issue	AW	AW
Rev	Date	Description	Drawn	Check

Heritage Designer Homes Ltd

Boyer

Project
 81 London Road,
 Maidstone

Drawing Title
 Proposed Planting Plan, Schedule &
 Management Plan

Drawing No: PL-105 Job Ref: 22.2012

Scale @ A1: 1:200 Revision: A

Scale Bar

Reproduced from the Ordnance Survey map with the permission of Ordnance Survey on behalf of The Controller of Her Majesty's Stationery Office. © Crown Copyright. All Rights Reserved. Boyer Planning Ltd. Creative House, New Hill Road, Worthingham, Berkshire, RG40 3JZ