

- Notes
1. PLANNING ISSUE DRAWING. THIS DRAWING SHOULD BE READ AS A PLANNING ISSUE AND SHOULD NOT BE USED FOR CONSTRUCTION UNDER ANY CIRCUMSTANCES.
 2. THE DESIGN HAS BEEN CARRIED OUT IN ACCORDANCE WITH ALL CURRENT WORKING DRAWINGS PROVIDED BY PENTLAND HOMES. PLEASE REFER TO STEN ARCHITECTURE HOUSE TYPE WORKING DRAWINGS TO CONFIRM LOCATIONS OF ALL DRAINAGE OUTLETS. ANY DISCREPANCIES SHOULD BE REPORTED TO THE ENGINEER IMMEDIATELY, PRIOR TO COMMENCEMENT OF ANY WORKS ON SITE.
 3. THIS DRAWING IS BASED UPON EXTERNAL INFORMATION. STEN ARCHITECTS' SITE BASE PLAN LAYOUT, DRAWING REFERENCE: 2280.PL.01 - PLANNING LAYOUT REV A DATED: 18.10.23. TOPOGRAPHICAL SURVEY BASE UPON FOX LTD DRAWING REFERENCE: 220303/C EXCAVATION AND RESTORATION DATED: 06.09.2022

CONSTRUCTION (DESIGN AND MANAGEMENT) REGULATIONS 2015

DESIGNER'S HAZARD INFORMATION FOR CONSTRUCTION

1. IF YOU DO NOT FULLY UNDERSTAND THE RISKS INVOLVED DURING THE CONSTRUCTION OF THE ITEMS INDICATED ON THIS DRAWING ASK YOUR MANAGER, HEALTH & SAFETY ADVISOR OR A MEMBER OF THE DESIGN TEAM BEFORE PROCEEDING.
 2. STRIKING CHARTED AND UNCHARTED BURIED AND OVERHEAD SERVICES INCLUDING BURIED HV & OVERHEAD EHV, GAS ETC.
 3. DEEP DRAINAGE EXCAVATIONS. RISK OF FALLS, COLLAPSE OF TRENCH OR BATTER, CONFINED SPACES.
 4. CONFLICT BETWEEN CONSTRUCTION WORKERS, VISITORS AND GENERAL PUBLIC WITH MOVING PLANT AND VEHICLES.
 5. WORKS ADJACENT TO AND WITHIN PUBLIC ADOPTED HIGHWAY. CONFLICT BETWEEN CONSTRUCTION WORKERS/ACTIVITIES AND MOVING VEHICLES.
 6. BANKING/ GRADING BETWEEN SITE BOUNDARY AND ADJACENT HIGHWAY STEP IN PLACES. MEASURES TO BE IMPLEMENTED TO ENSURE WORKERS AND GENERAL PUBLIC ARE SAFE.
 7. SPECIAL ATTENTION SHOULD BE PAID TO OVERHEAD CABLES PRESENT ADJACENT TO SWALE ROAD AND GROVEHURST ROAD.
 8. EXISTING GAS MAIN PRESENT ALONG NORTH EASTERN EXTENT OF THE SITE. CARE TO BE TAKEN WHEN WORKING IN CLOSE PROXIMITY TO MAIN. MAIN TO BE MARKED OUT ON SITE TO ENSURE THE LOCATION OF MAIN IS KNOWN PRIOR TO SITE CONSTRUCTION WORKS.
- THE ABOVE NOTES REFER SPECIFICALLY TO THE INFORMATION SHOWN ON THIS DRAWING. REFER TO THE HEALTH AND SAFETY PLAN FOR FURTHER INFORMATION.

DRAWING FOR INFORMATION
NOT FOR CONSTRUCTION

Rev.	Description	By	Chk.	Date
P1	PLANNING ISSUE	AH	JR	27.10.23

barterhill
Barter Hill Partnership Limited
Greenway Business Centre
Greenway
Harlow Business Park
Essex CM19 5QE
t: 01279 430888
e: mail@barterhill.co.uk

Consulting Structural & Civil Engineers
15 Meridian Way
Meridian Business Park
Norwich NR7 0TA
t: 01603 300360
e: mail@barterhill.co.uk

Client
Pentland Homes

Project
GREAT GROVEHURST FARM SITTINGBOURNE

Drawing Title
DRAINAGE STRATEGY PLAN SHEET 4

Designed by AH	Drawn by AH	Checked by JR
Scale @ A1 1:250	Contact Office NORWICH	Date OCTOBER 2023

Status PLANNING ISSUE	Revision P1	Job Ref 9383
--------------------------	----------------	-----------------

Drawing No.
9383-BHP-XX-XX-DR-C-0114

Cad file
P:9383/Civils/BHP Drawings/9383-BHP-XX-XX-DR-C-0114

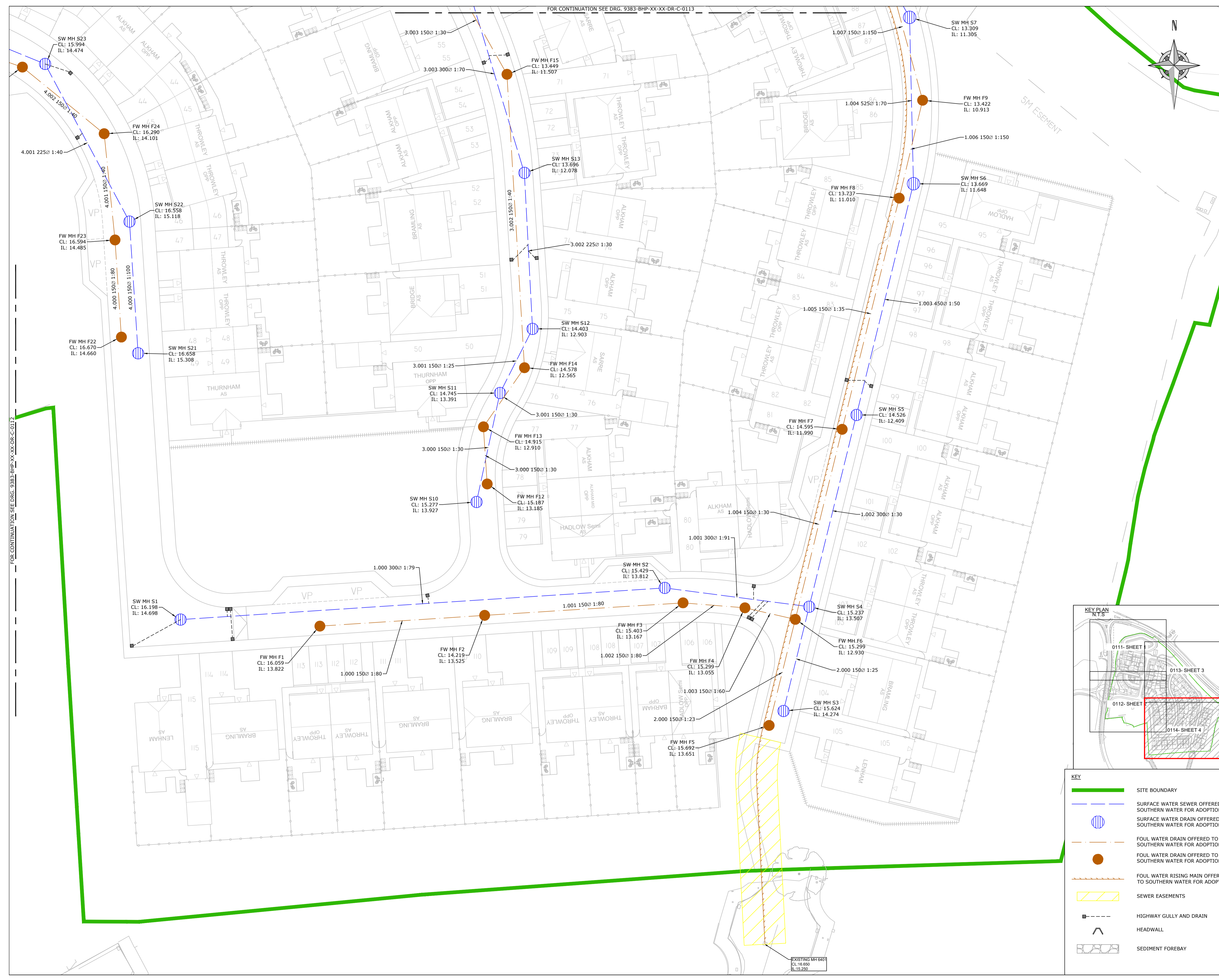

KEY

- SITE BOUNDARY
- SURFACE WATER SEWER OFFERED TO SOUTHERN WATER FOR ADOPTION
- SURFACE WATER DRAIN OFFERED TO SOUTHERN WATER FOR ADOPTION
- FOUL WATER DRAIN OFFERED TO SOUTHERN WATER FOR ADOPTION
- FOUL WATER DRAIN OFFERED TO SOUTHERN WATER FOR ADOPTION
- FOUL WATER RISING MAIN OFFERED TO SOUTHERN WATER FOR ADOPTION
- SEWER EASEMENTS
- HIGHWAY GULLY AND DRAIN
- HEADWALL
- SEDIMENT FOREBAY