

Floor Plans

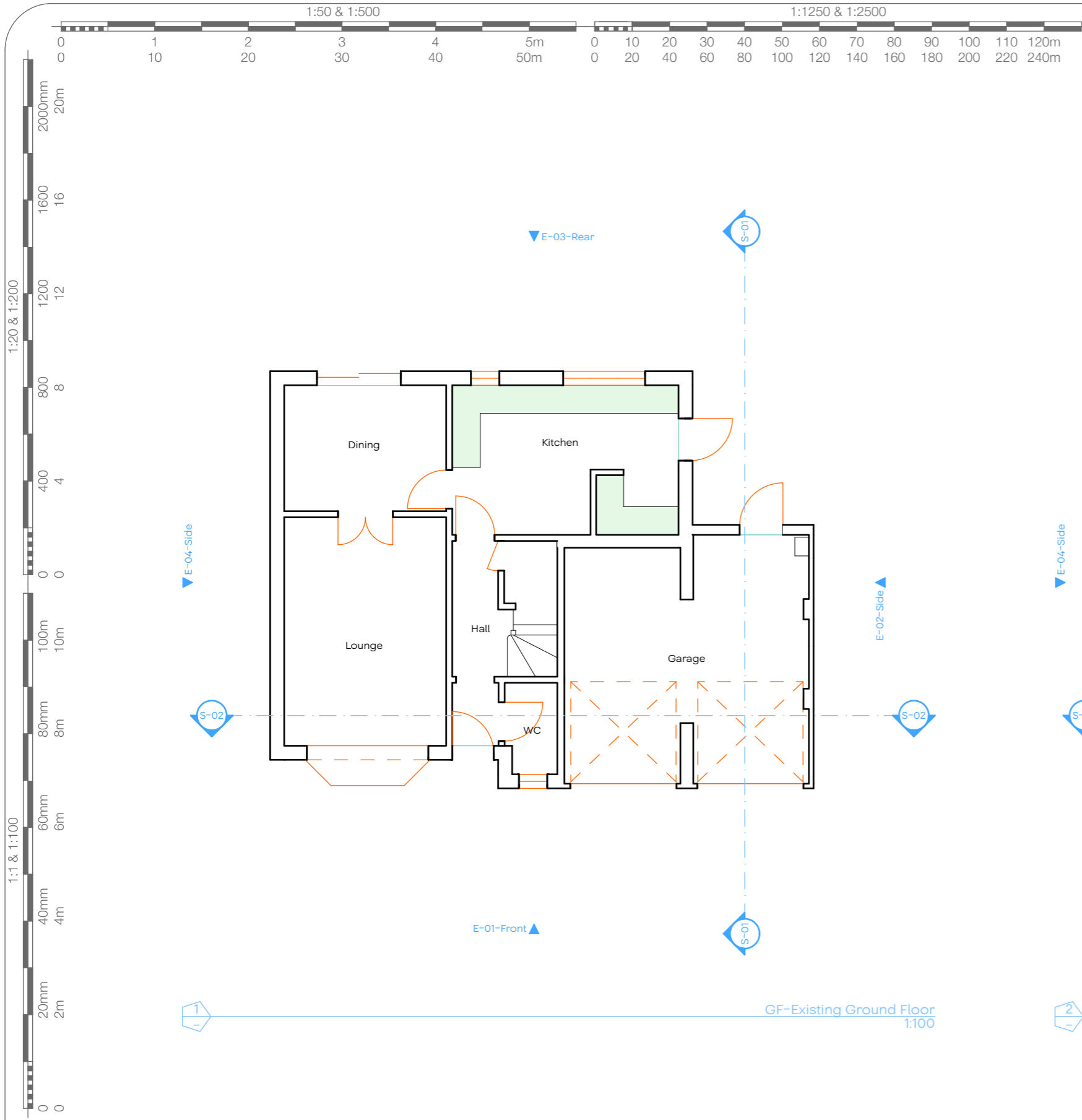

GF-Existing Ground Floor
1:100

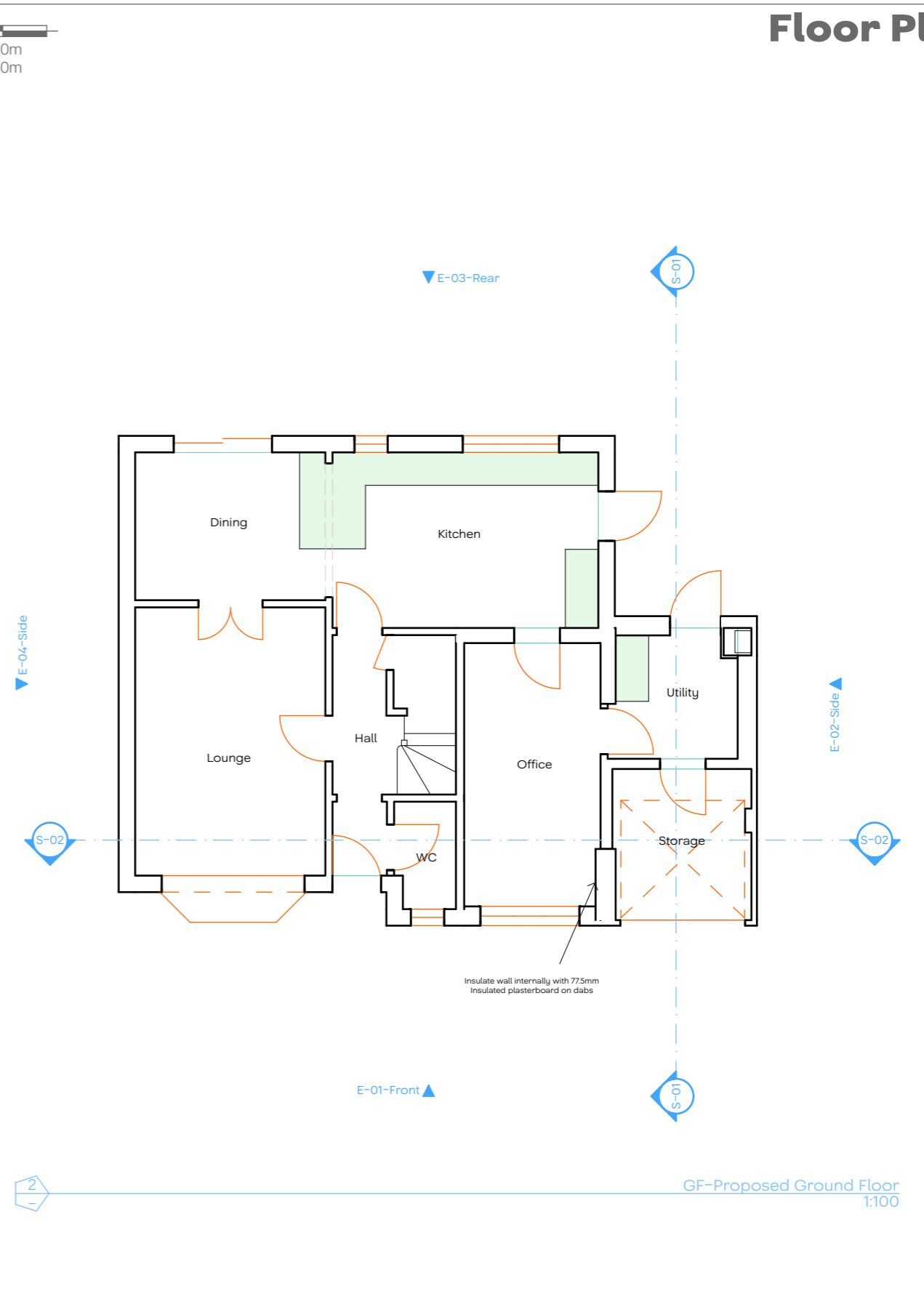

GF-Proposed Ground Floor
1:100



**JOHN CHILDS
ARCHITECTURAL
DESIGN**

Address :- 52 Peveral Drive, Bearsted, Kent	Scale :- As Marked	Date :- April 2023	Drawing No. :- P.01	Revision Notes :-
Project :- Garage conversion and internal alterations	Paper Size :- A3	Drawn by :- JLRC	Revision No :-	

www.johnchilds.com 01622 812868

The copyright in this plan shall be the absolute property of John Childs Architectural Design and shall not be reproduced either in whole or part without their expressed permission.
All measurements to be checked on site prior to any works undertaken