

NOTES:

- 1. This drawing is the property of MJF CAD Solutions and must not be copied or disclosed for any purpose except as authorised by MJF CAD Solutions or the client.

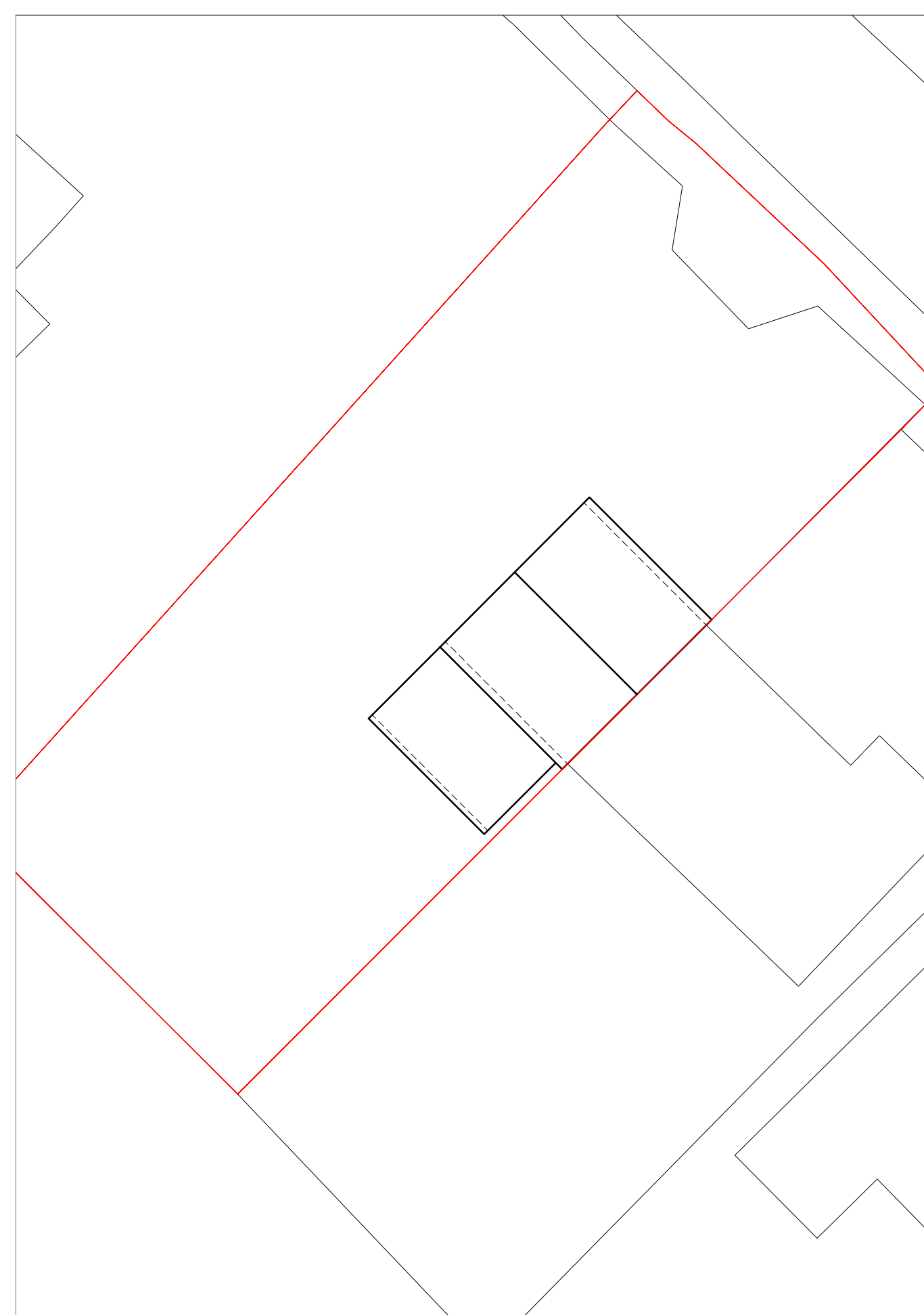

Existing Block Plan

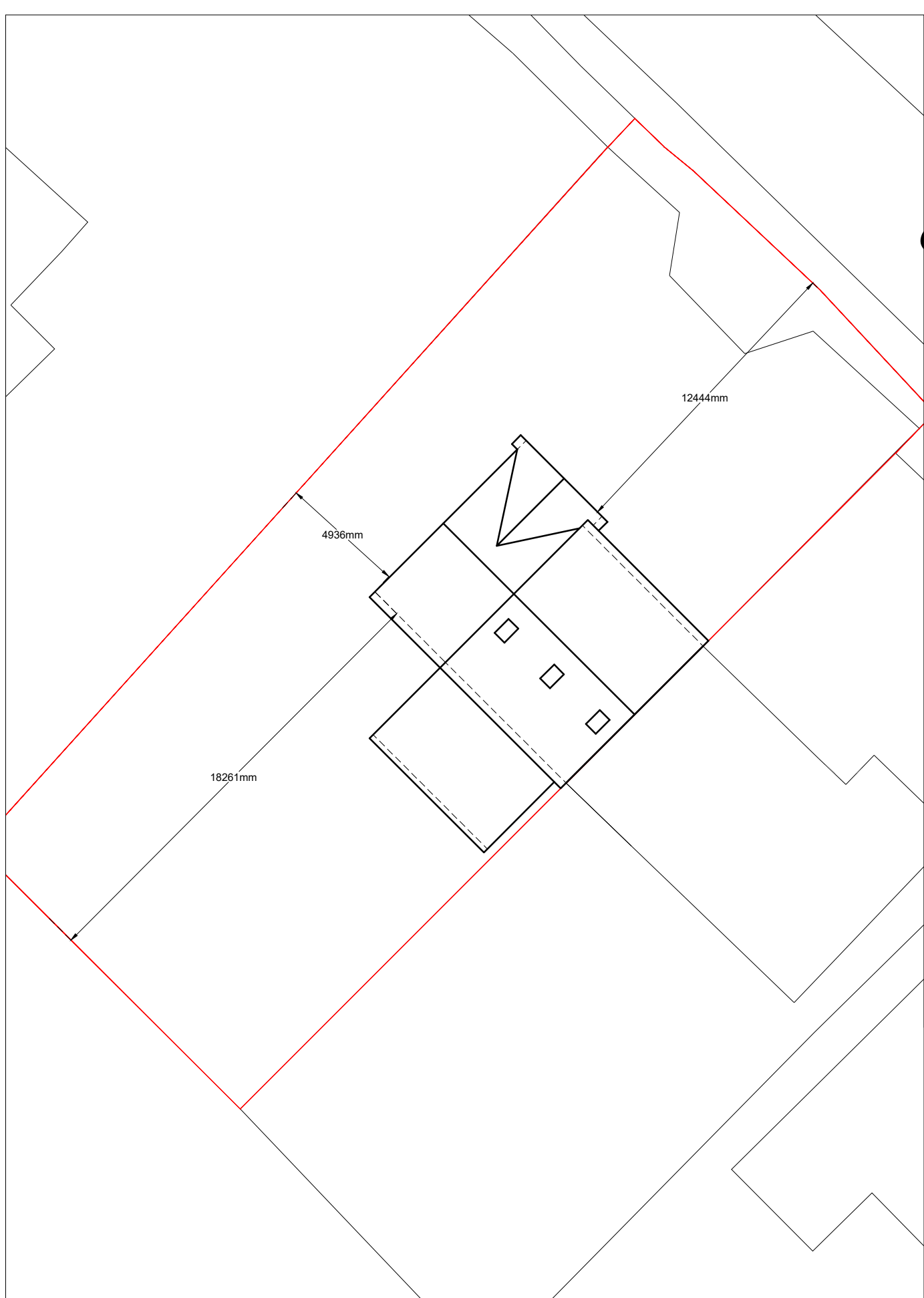

Proposed Block Plan

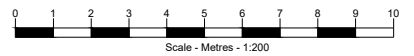

Rev	Date	By	Chk	Comment
A	Feb 24	MJF	MJF	Revised to suit planning

Rev	Date	By	Chk	Comment



MJF CAD Solutions
 Basepoint Business Centre, Rivermead Drive
 Swindon, SN5 7EX
 Tel: 01793 407941 - Mob: 07783 226700
 Email: mike@mjfcadsolutions.co.uk
 Website: www.mjfcadsolutions.co.uk



Client
 Mr Harris
 Cotswold
 Clacton Road
 CO16 9DZ

Project Title
 2 Storey Side Extension

Drawing Title
 Existing & Proposed Block Plans

Drawn by: MJF Scale: 1:200 - A3 Date: Dec 2023

Drawing No. 1152_04 Rev. A